

Installation Instructions 3/4" Thermostatic Valve Rough-in & Trim (PL8950)



CONTENT

- 02 - Valve & stop valve specifications
- 03 - Face plate specifications
- 04 - Handle specifications
- 05 - Shower head & arm specifications
- 06 - Body sprays & rain bar specifications
- 07 - Tub spout specifications
- 08 - Valve installations
- 11 - Stop valve Installations
- 13 - Shower head & arm Installations
- 14 - Body sprays & rain bar Installations
- 15 - Tub spout Installations
- 16 - Custom shower combinations



Before Your Installation

- Read all instructions carefully.
 - Assemble all tools.
 - Turn off main water supply before removing old faucet and fixtures.
 - Clean surface before installing new faucet.
 - Insert a cloth or stopper into drain to prevent small parts from getting lost.
 - HB recommends that when cleaning you HB faucet to only use soap and warm water.
- The use of any chemical substance will void finish warranty

Help Info? Please call Toll-FREE customer service line at 1-800-888-6604 for additional assistance service.

Tips for Successful Installations

- Use joint compound or Teflon® tape on all threaded connections to prevent leaks.
- Use a soft cloth to protect the faucet's finish when using a wrench, pliers or other tools that could scratch the faucet.
- Tighten all hose connections by hand. Do not over tighten.
- Before turning main water supply back on, open several faucets around the house to prevent pressure from building up. Remove aerator from faucet before turning on water. Flush drain for several minutes before replacing aerator. DO NOT use joint compound or Teflon® tape to reconnect aerator.
- DO NOT use "plumbers putty" or any oil based sealant. HB recommends silicon caulking to be use to seal drain flange and other parts.
- If you experience problems with the installation consult a professional plumber.



11100 Dana Circle Cypress, CA 90630
Tel : 800-888-6604 | Fax : 888-455-5007
www.huntingtonbrass.com

Thermostatic Valve - PL8950

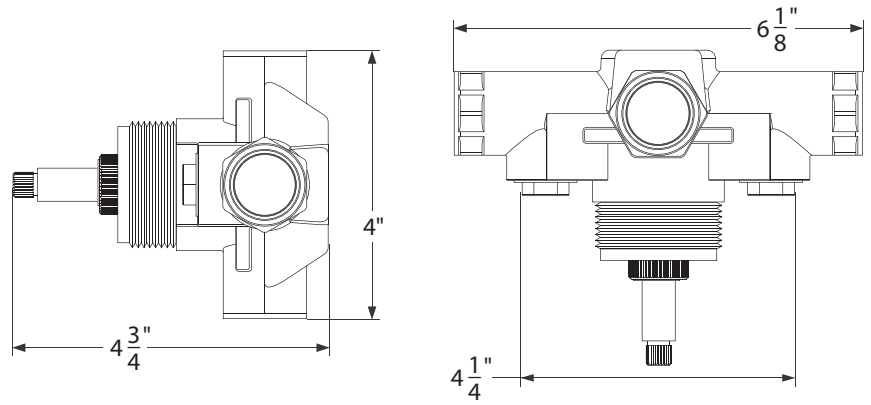

Installing the HB 3/4" Thermostatic Valve

- The plumbing lines used in installation must be copper pipes
- When soldering copper connections the plumber must first remove the thermostatic cartridge before applying heat. Refusal to follow this step will void the warranty. HB will not be responsible for any damage or defect in function due to this neglect.
- Look carefully at the diagrams provided on the installation sheet.
- The HB thermostatic valve is designed to run with only one outlet port open. The valve comes with the bottom port plugged. This plug can be switched if the installation requires it.
- When installing the trim, the stem length may have to be cut to specific dimensions to fit certain styles of trims.

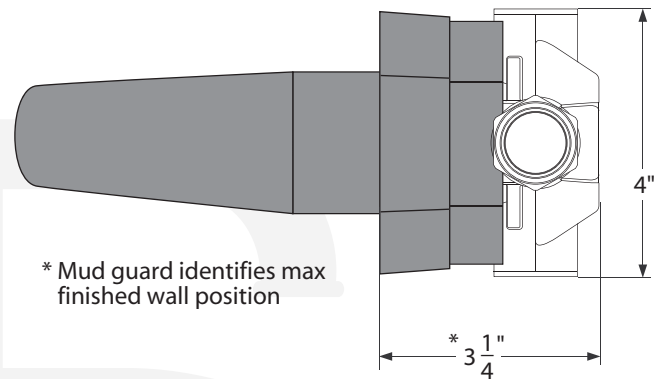

In Wall 3/4" Stop Valve - PL2000W

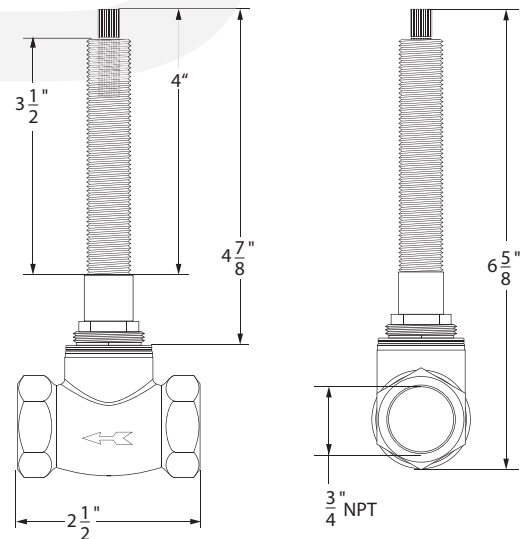

Installing the HB in wall 3/4" stop valve

- The plumbing lines used in installation may be copper pipes
- When soldering copper connections DO NOT overheat the valve body. If this is foreseen as a potential problem be sure to remove cartridge components before applying heat.
- Look carefully at the diagrams provided on the reverse side of the installation sheet.
- Be sure to install the valve such that the arrow marking on the valve is consistent with the direction of water flow.
- When installing the trim, the stem and thread lengths may have to be cut to specific dimensions to fit certain styles of trims. Trim installation is shown on the reverse side. To show how to install various HB trims that require different stem lengths.

PL9961-xx

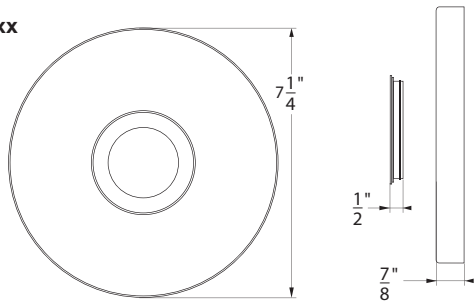

PL9962-xx

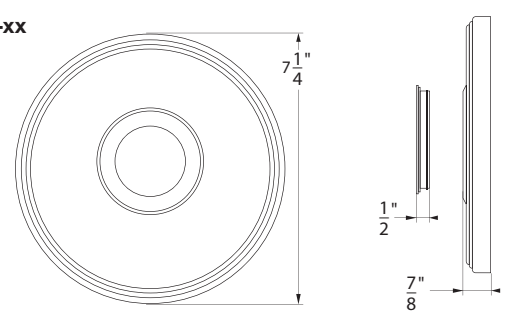

PL9922-xx

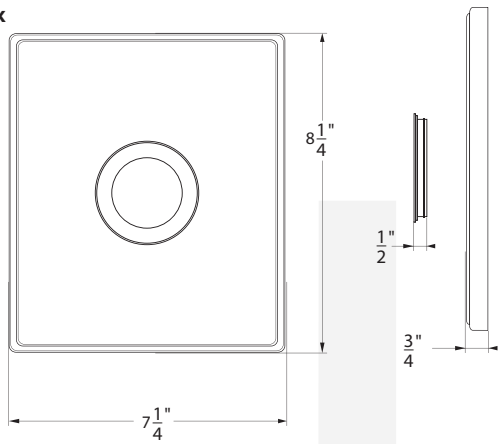

PL9966-xx

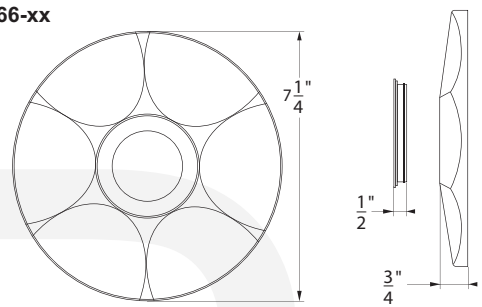

PLxxx-xx

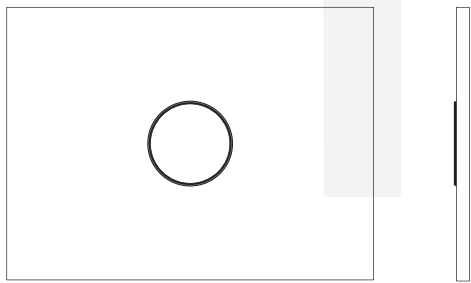

PLxxxxx

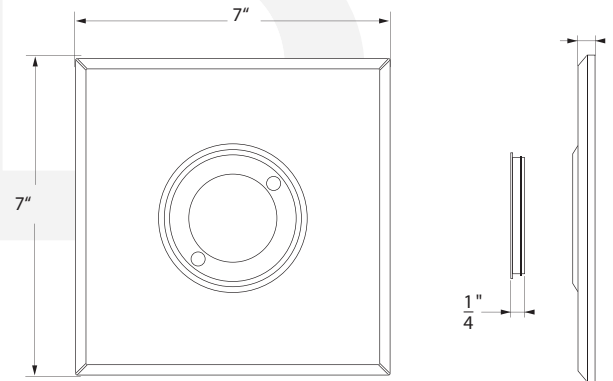

PLxxx-xx

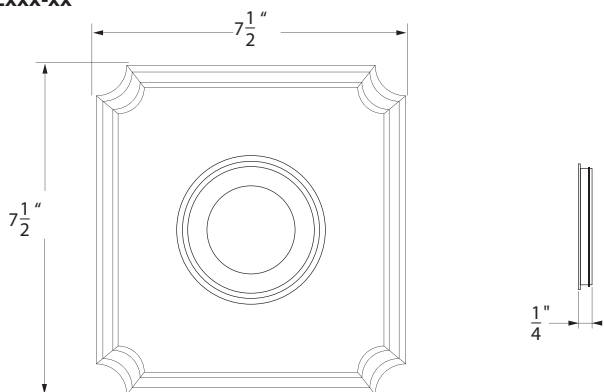

Handle Tip PL - xx
Escutcheons J - xx

Handle Tip ML - xx
Escutcheons J - xx

Handle Tip ZL - xx
Escutcheons B - xx

Handle Tip ZX - xx
Escutcheons B - xx

Handle Tip BJ - xx
Escutcheons L - xx

Handle Tip JL - xx
Escutcheons D - xx

Handle Tip BX - xx
Escutcheons R - xx

Handle Tip AL - xx
Escutcheons R - xx

Handle Tip DL - xx
Escutcheons W - xx

Handle Tip CL - xx
Escutcheons C - xx

Handle Set: ASL - xx
*Atlantis handle set

Handle Set: WBL - xx
*Wyndamere handle set

Handle Tip FFL - xxS
*Favari handle set

Handle Tip IIL - xxS
*Intrigue handle set

Handle Set: MNL - xx
*Monarch handle set

Handle Set: MDX - xx
*Monarch handle set

Handle Set: CXX - xx
*Chameleon handles offer different base options (see catalog for details)

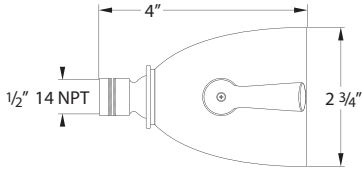

138-xx

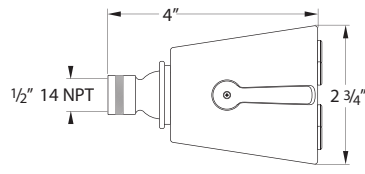

234-xx

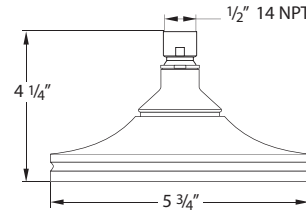

PLxxISQ

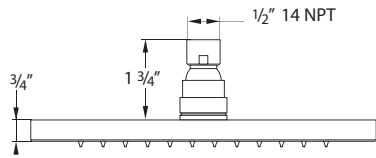
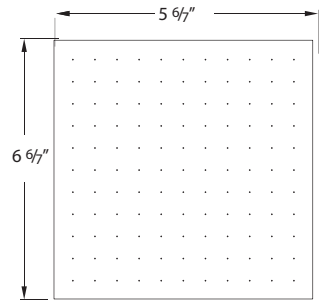

PLxxFSH

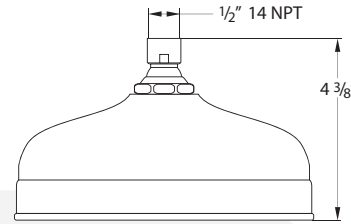
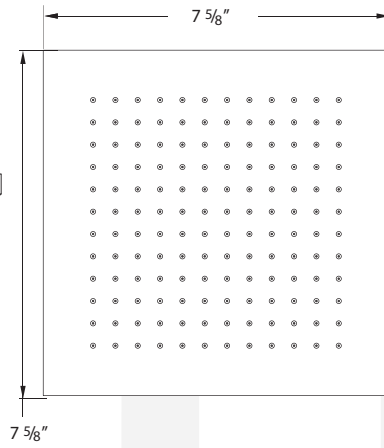

PLxxSH8

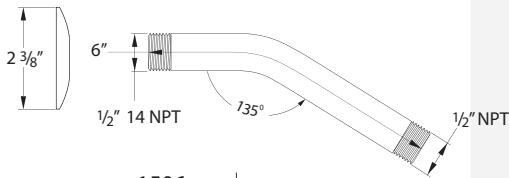
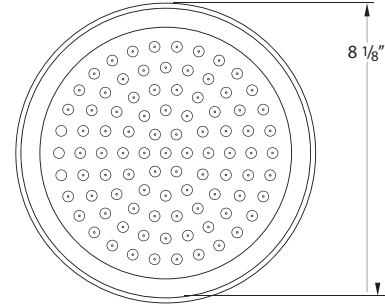

1506-xx

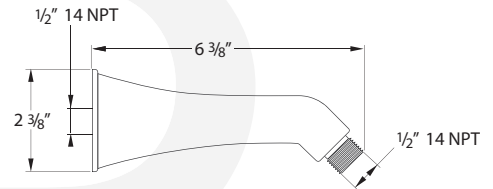

PLxxASA

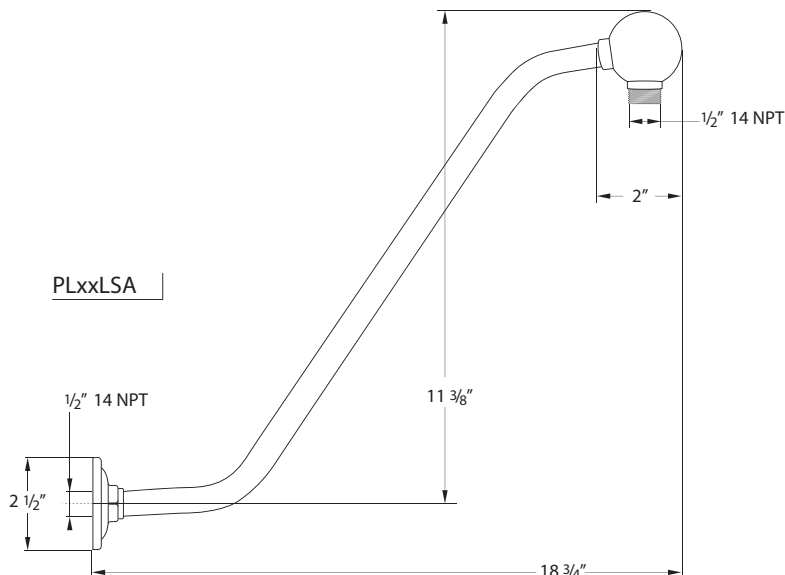

PLxxLSA

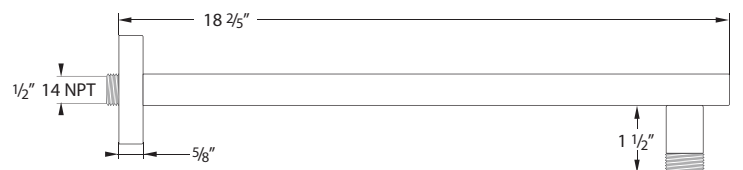
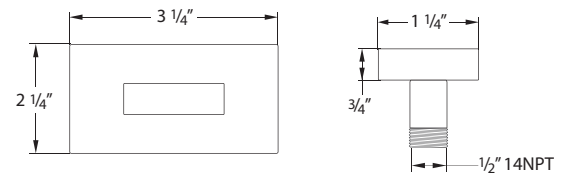

PLxxFSA

Body Sprayer - 161-xx / 162-xx / 164-xx 166-xx

- Contemporary, Classic, Atlantis, and Hex style body sprays.
- Easy clean rubber nipples.
- Adjustable angle spray.
- 1/2" IPS connection for easy installation.
- Adjustable brass flange with set screw.
- Available in all Huntington Brass special finishes.

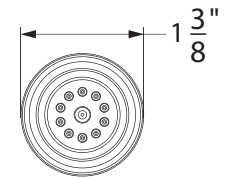
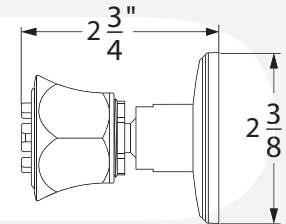
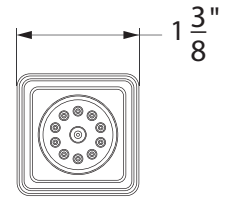
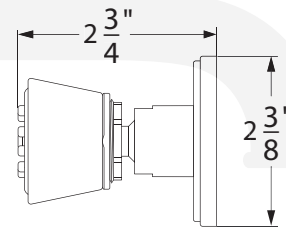
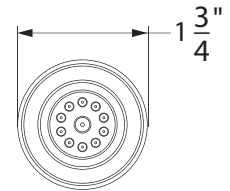
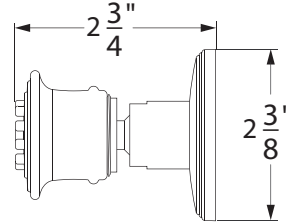
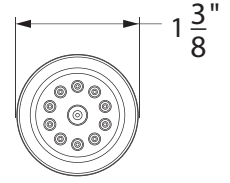
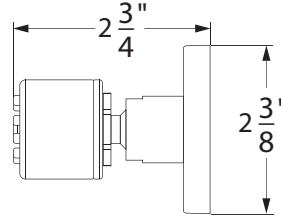

Rain Bar - RB100-xx

- 31 brass nipple jet rain bar.
- 1/2" FIP connections
- Adjustable with in 1/2" for easy installation.
- Spray bar rotates 360°.
- Available in all Huntington Brass special finishes.

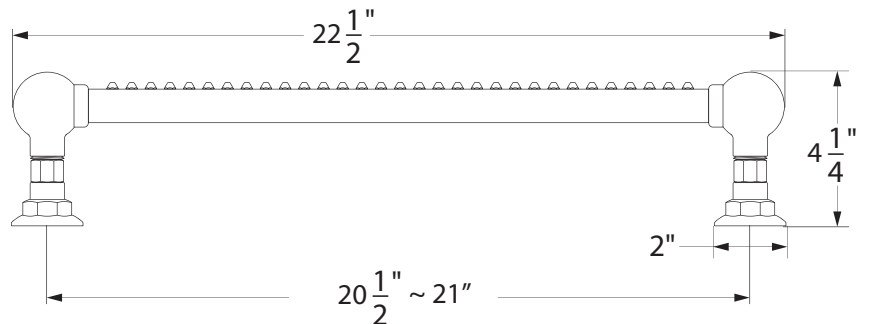
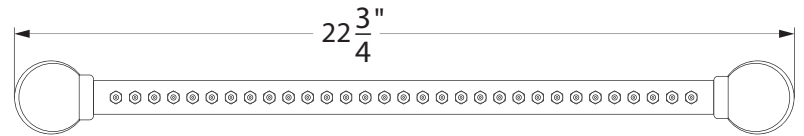

PLHSPxx

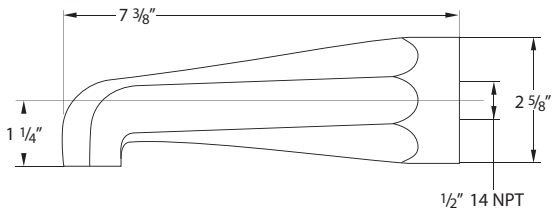

PLRSPxx

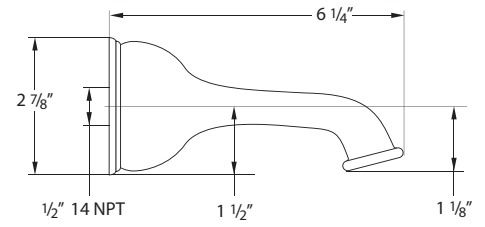

PLWSPxx

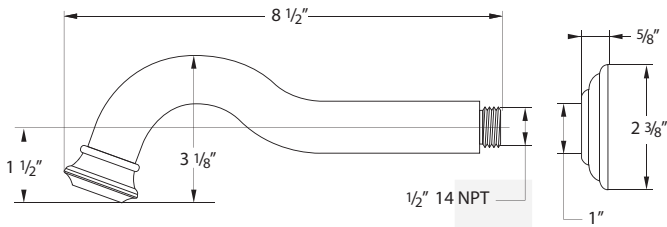

PLCTSxx

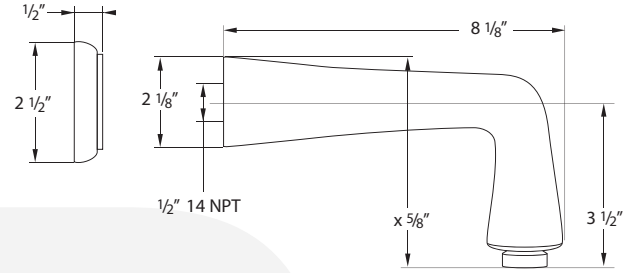

PLBSPxx

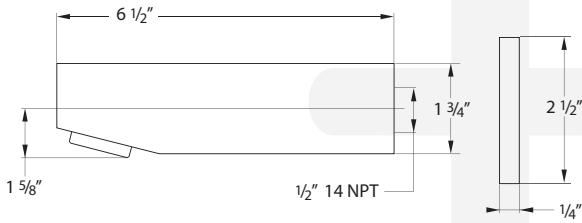

PLTSPxx

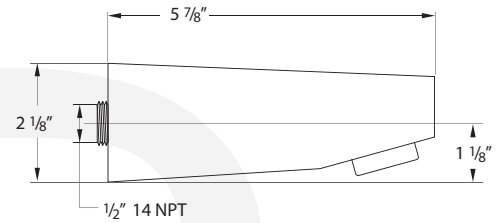

PLASPxx

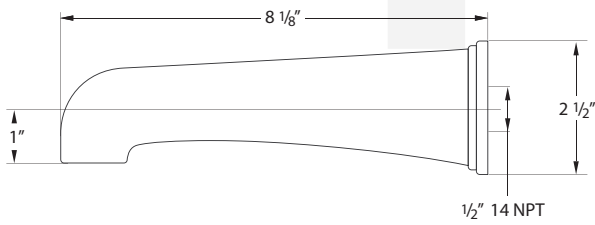

PLFSPxx

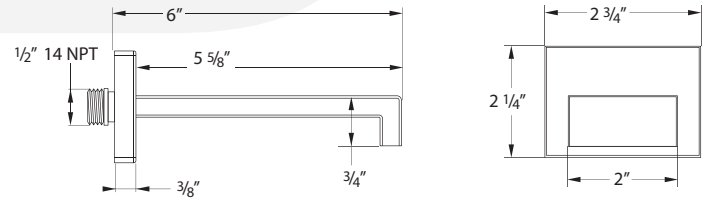

PLISPxx

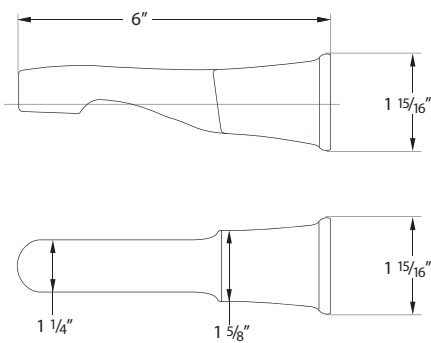

PLMSPxx

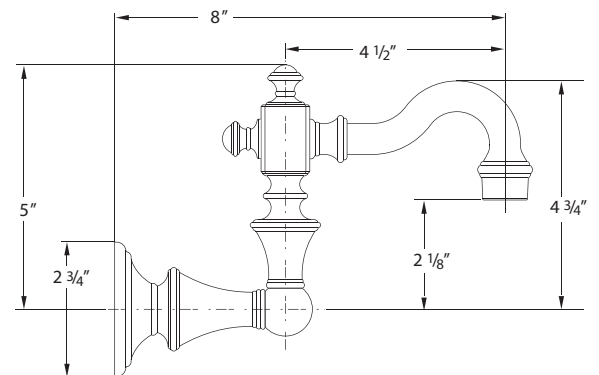

1

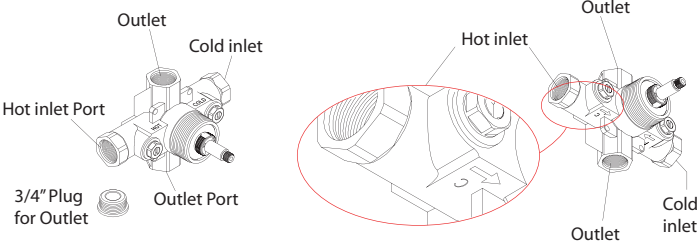

Outlet
Cold inlet
Hot inlet
Hot inlet Port
3/4" Plug for Outlet
Outlet Port
Outlet
Cold inlet

2

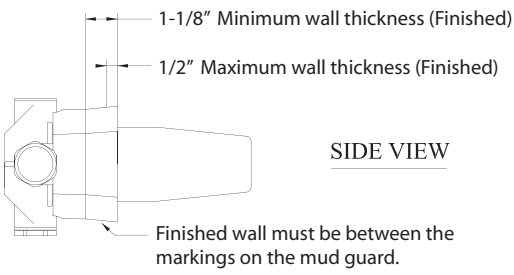

1-1/8" Minimum wall thickness (Finished)
1/2" Maximum wall thickness (Finished)
SIDE VIEW
Finished wall must be between the markings on the mud guard.

Please note that the valve is stamped with "HOT" & "COLD" on the top and "C" (chaud / hot) and "F" (froid/cold) on the bottom. The valve is designed with two outlets for ease of installation, but are not intended to be used simultaneously. Using both outlets will reduce the performance of the valve. Determine which outlet port will be used for the installation and plug the other outlet with the 3/4" plug provided.

Make sure the tile guide is firmly secured to the valve and determine the proper location for the mixing valve. The from edge of the tile guide must be a minimum of 1/2" beyond the finished wall and no more than 1-1/8". Determine the proper orientation of the valve (see step 1). A reverse cartridge is available, but there is a reduction of 25 percents in the output of the valve.

3

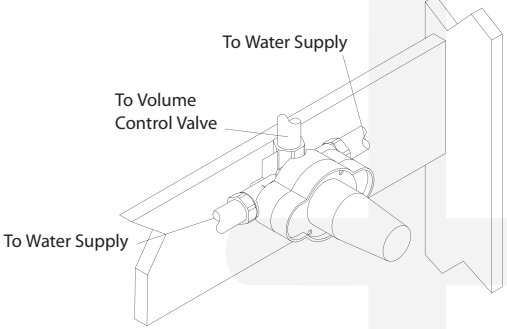

To Water Supply
To Volume Control Valve
To Water Supply

4

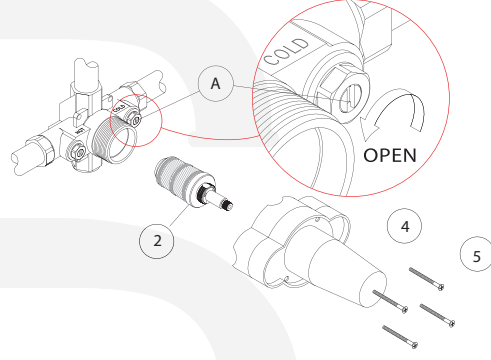

A
COLD
OPEN
2
4
5

Once the location has been determined, install a cross beam. Level the valve and secure to the crossbeam. Connect the thermostat - mixing valve to the hot and cold supplies using copper supply lines and 3/4" male adaptors. (NOTE: Do not apply heat directly to the valves as this may damage rubber and plastic seals and will void the warranty). Connect the outlet port to the volume control valve (Huntington Brass volume control valves and trim kits are sold separately).

Flush supply lines. Remove the mounting screws (#5) and the tile guide (#4) Close integral stop (#A) by turning screwdriver slots clockwise fully. Remove cartridge (#2) by using a wrench and turning counter clockwise. Turn on water supply and open integral stops by turning screwdriver slots counter clockwise. Shut-off integral stops. Failure to complete this step will void the warranty.

5

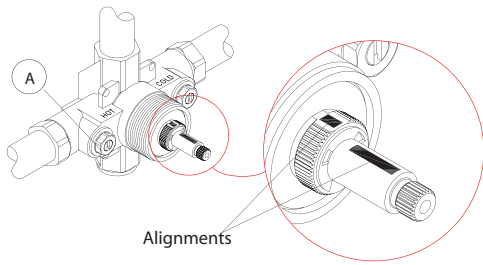

A
Alignments

6

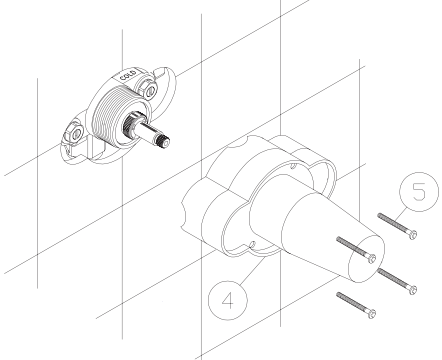

4
5

Reinstall cartridge. Make sure that the alignment marks on the cartridge stem are on the top of the cartridge. Secure cartridge back. Open integral stops and flash lines to volume controls (s), outlet (s), etc. Check all connections for leaks. Close integral stops and reinstall tile guide. The wall is now ready to be closed.

Once the finished wall has been completed, removed black tile guide (#4)

7

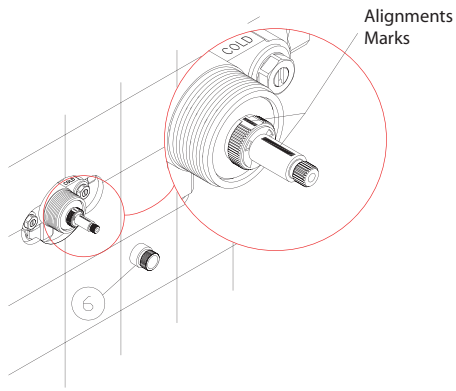

Make sure black alignment mark on the stem lines up with the mark on cartridge nut. Attach positioning cam (#6) to cartridge. Be sure that the fine broach of the cam is aligned with the cartridge and the cam is firmly positioned.

8

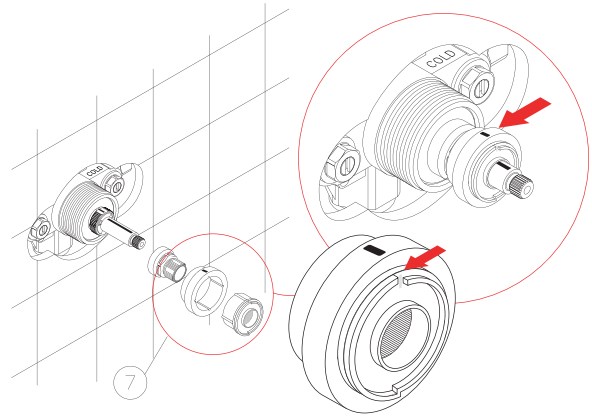

Place the black safety stop insert into the safety stop metal ring. Make sure that the opening in the black safety stop is lined up with the marking on the safety stop metal ring. The cartridges are factory calibrated, so the alignment mark on the safety stop (#7 see insert) must be located at the top. Line up the broach on the safety stop and the positioning cam and slip safety stop (#7) onto positioning cam. Take care not to strip the broach on the safety stop when attaching and be sure that it is firmly positioned.

9

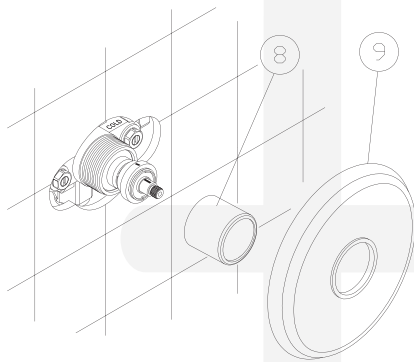

Thread the finished valve sleeve (#8) onto the thermostatic valve body. Check to make sure the seal ring is installed on the center hole of the plate (#9). Slide escutcheon plate onto sleeve until snug against finished wall. Use silicone caulking to seal the plate against the wall surface to avoid any leakage of water behind plate.

10

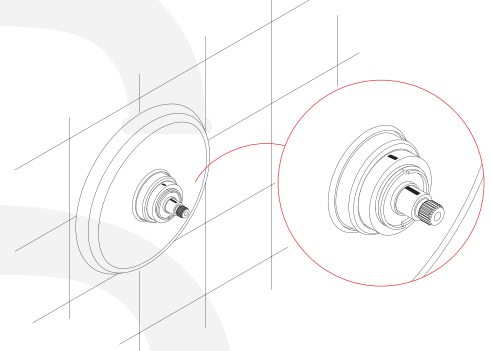

If the finished sleeve does not protrude beyond the finished escutcheon plate, an optional extension (#12) is available. If all installation specifications are followed there should be no need to use the optional extension kit. In the event that the installation instruction are not followed and an extension kit is needed HB does offer these parts, but will not assume any responsibility for the mistake. Please contact your local HB distributor if you have any questions.

11

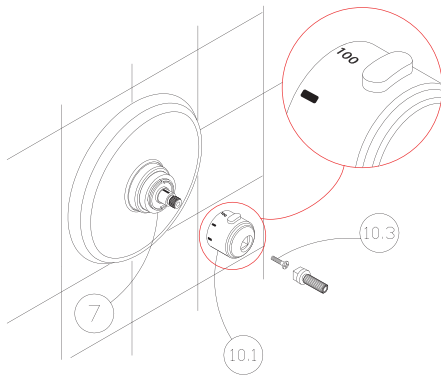

Attach the thermostatic handle base with temperature indicators (#10.1) to safety stop (#7) and stem. The red safety button (marked 100°) should be placed at the top. Secure the handle with the screw provided.

12

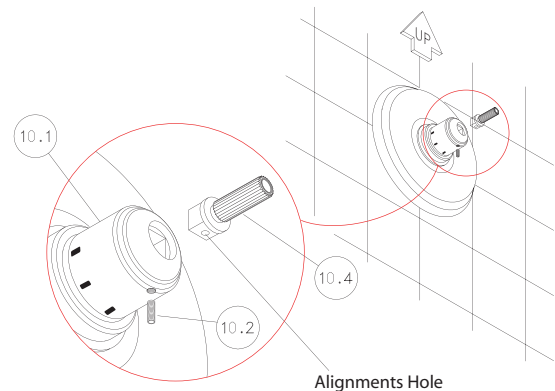

Orient handle broach stem (#10.4) so that the alignment hole is pointed down and insert into the handle base (#10.1). Stem should seat snugly in base with the alignment hole lined up with threads tapped on the underside of the handle base. Secure stem with setscrew (#10.2) provided.

13

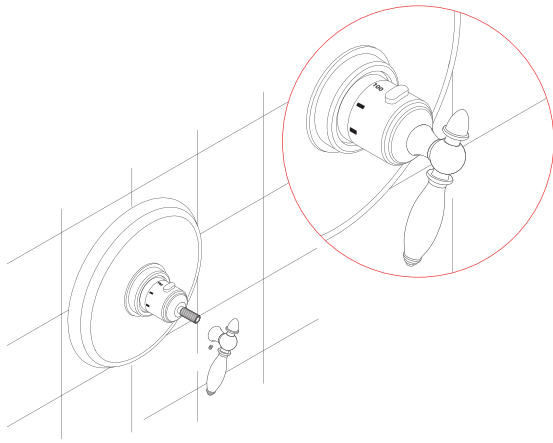

Finally, attached the handle tip to the stem. (Note: handle trim varies with series and can be mounted in any desired position). The stem may be trimmed to fit if the stem length is too long.

14

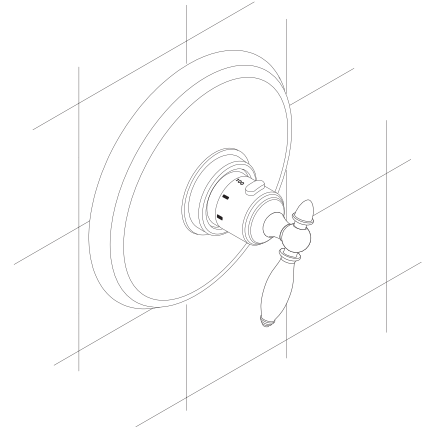

Once the handle tip is in the desired position, secure the handle tip with the side set screw provided (or some handles may use a top side screw that will screw into the tapped thread in the broach stem)

Extension Kit Installation

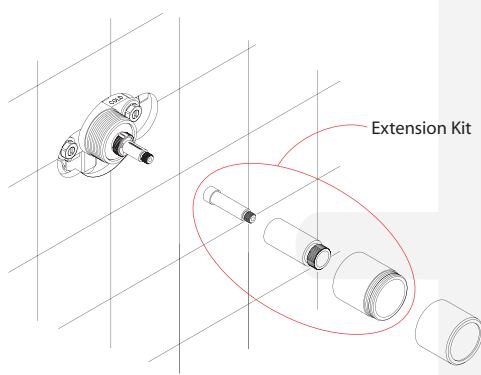

The thermostatic valve extension kit consists of 3 main components. 1) Broach extension 2) positioning cam extension 3) sleeve extension & 4) long handle screw. All of these parts are easily installed on to the valve body with out making any adjustments.

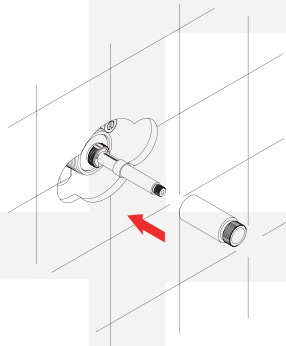

First, place the broach extension piece on to the thermostatic cartridge broach stem. This will later be secured when the handle trim is installed using the longer handle screw to reach the broach thread. Next, place the cam extension onto the cartridge.

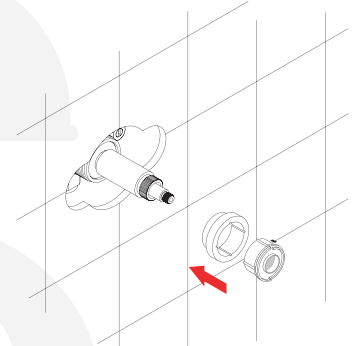

Next, follow the same directions as step #8 in the installation instructions to assemble and install the safety stop ring onto the positioning cam extension piece.

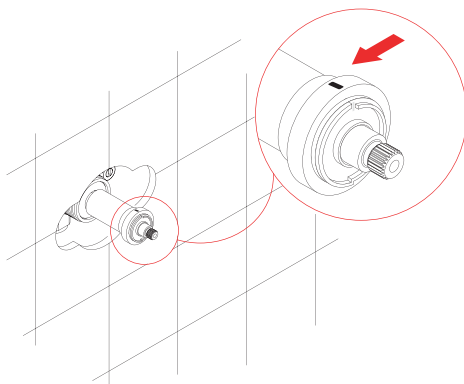

When installing the safety stop ring make sure to line up the marking on the metal ring with the calibration markings on the cartridge placing all marking aligned at the top position.

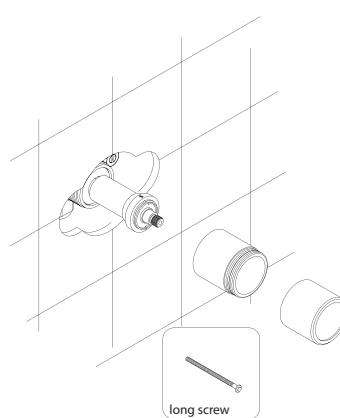

Finally, install the sleeve extension onto the valve body. Once all of the extension components are installed you can install the rest of the trim parts as normal using the long screw for the handle trim in place of the existing short screw.

Important

Valve stem & thread will have to be cut differently to fit various trims. Make sure that no part of the valve is altered until trim is in hand ready to install. HB will not assume responsibility for installation negligence.

Favari trim needs the valve to be set further into the wall, see installation page for that trim.

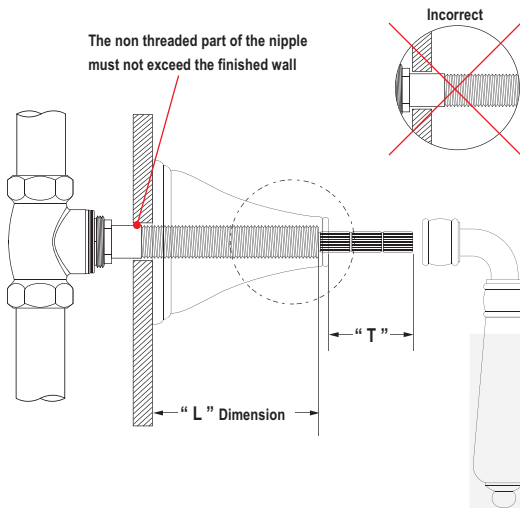

1 Finding the “L” Dimension

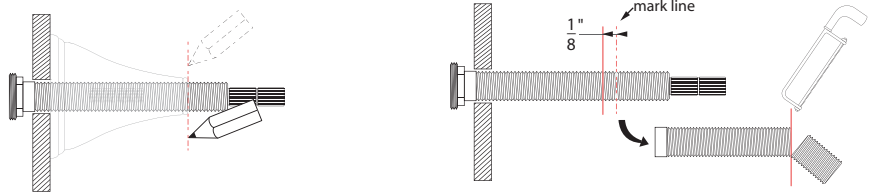

To find the “L” dimension after the rough-in is installed and the finished wall is completed, first install the handle escutcheon and ring (if applicable). Mark the threaded nipple where the escutcheon ends. Remove the nipple by unscrewing and then cut the nipple 1/8" below the marking to ensure that the handle tip will fit flush with the escutcheon. Once the nipple is cut to the proper length, reinstall onto the cartridge stem, and prepare to measure the “T” dimension for the stem length.

2 Finding the “T” Dimension

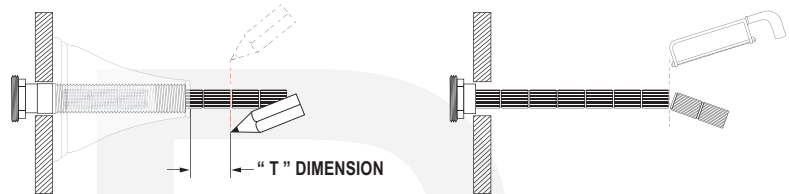

To find the “T” dimension, first reinstall the escutcheon and base ring after the threaded nipple has been cut to the correct length. Make sure that none of the threaded nipple is protruding from the escutcheon. Next, cut the broach to the specific “T” dimension for the handle style that is applied. Cut the broach stem at the notch area if possible, if not then some filing of the end of the stem may be needed to fit the handle tip on the stem.

Before Installing Handle Trim

1. “L” dimension - The “L” dimension is the length that the all thread (9/16-20) nipple should be cut to for applicable trim installation. To find the “L” dimension, see step 1 of the trim installation process.

2. “T” dimension - The “T” dimension is the length of the stem that should protrude from the escutcheon base after the nipple is marked, cut and installed back on the valve.

3

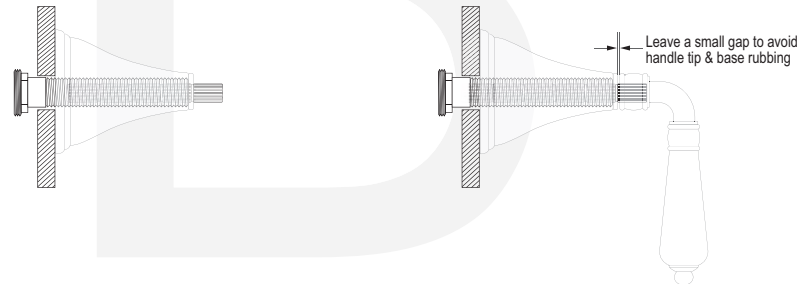

Finally, after the threaded nipple and the stem are cut to the proper dimensions for the trim to be installed, you can install the handle trim parts. First, place the ring or flange on and screw the handle escutcheon onto the threaded nipple until tight. HB advises using silicone caulking where the wall and the escutcheon meet. Next, install the handle tip by sliding the handle tip onto the stem and securing with the set screw (some handles may use a top down screw to install) Make sure the handle tip is pointed down in the off position.

4a Special Installation for Bellezza / Chameleon / Atlantis / Wyndamere

Bellezza

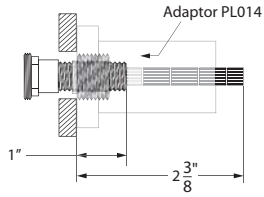

Atlantis

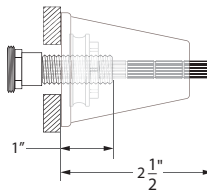

Chameleon

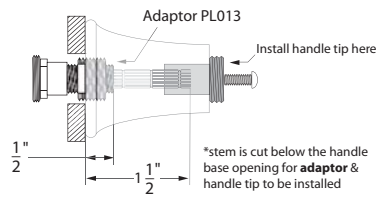

Wyndamere

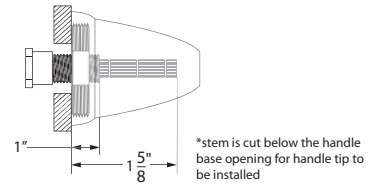

4b Special Installation for Favari / Intrigue / Monarch

Favari

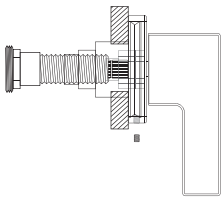

Monarch (Lever)

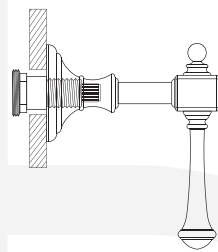

Intrigue

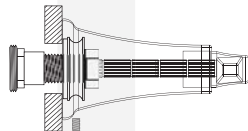

Monarch (Droop)

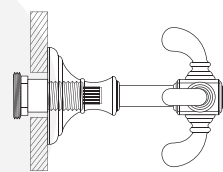

Important

Valve stem & thread will have to be cut differently to fit various trims. Make sure that no part of the valve is altered until trim is in hand ready to install. HB will not assume responsibility for installation negligence.

IMPORTANT !

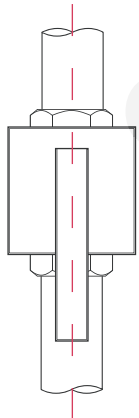
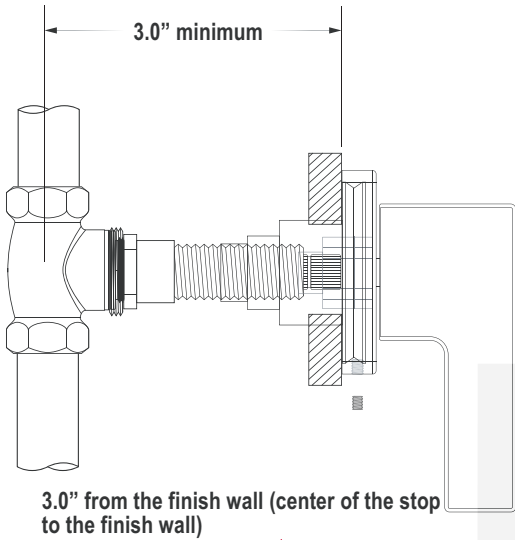

When roughing in the valve, test fit the handle to make sure it will be in the desired final position.

STEP 1

IMPORTANT !

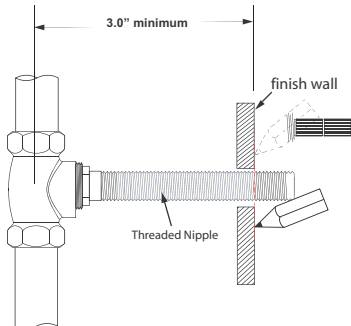

After the rough-in is installed and the finished wall is completed, mark the threaded nipple where it is flush with the wall surface.

STEP 2

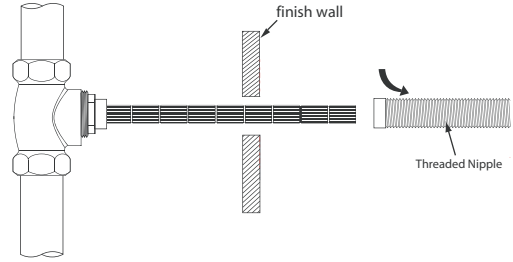

After marking threaded nipple unscrew it from the valve.

STEP 3

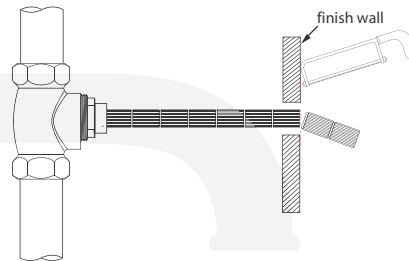

Cut the 16 point stem flush with the finished wall.

STEP 4

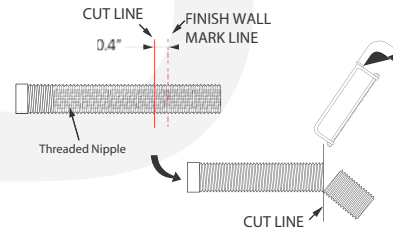

Measure 0.4" from the finish wall marking line. Cut threaded nipple so it will sit 0.4" inside the finished wall.

STEP 5

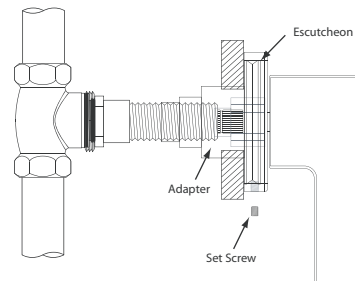

Install threaded nipple onto the valve. Install adapter onto the threaded nipple. Install handle and escutcheon onto the adapter and tighten set screw.

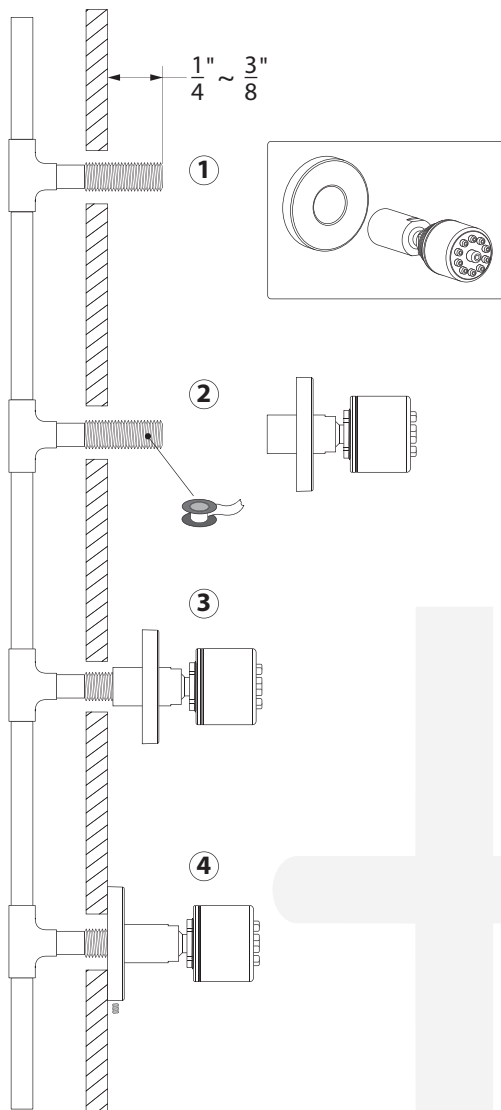

When installing body sprays a pressure balancing loop is required for all body sprays that will be functioning simultaneously. This will ensure that the performance and water pressure output for each spray head uniform.

1. Install 1/2" IPS threaded copper nipples (NPT thread can also be used) such that they are 1/4" ~ 3/8" beyond the surface of the finished wall.
2. Teflon tape is not needed on these copper lines since the ball joint for each body spray is 1/2" IPS thread with rubber washers.
3. Install the body spray flange onto the ball joint of the body spray.
4. Using a cloth to protect the finished parts from the wrench install the body spray to the copper nipples.
5. Set the flange in appropriate location against the wall. Tighten the set screw to secure. Use silicone caulking around the flange to seal any gap between the wall.

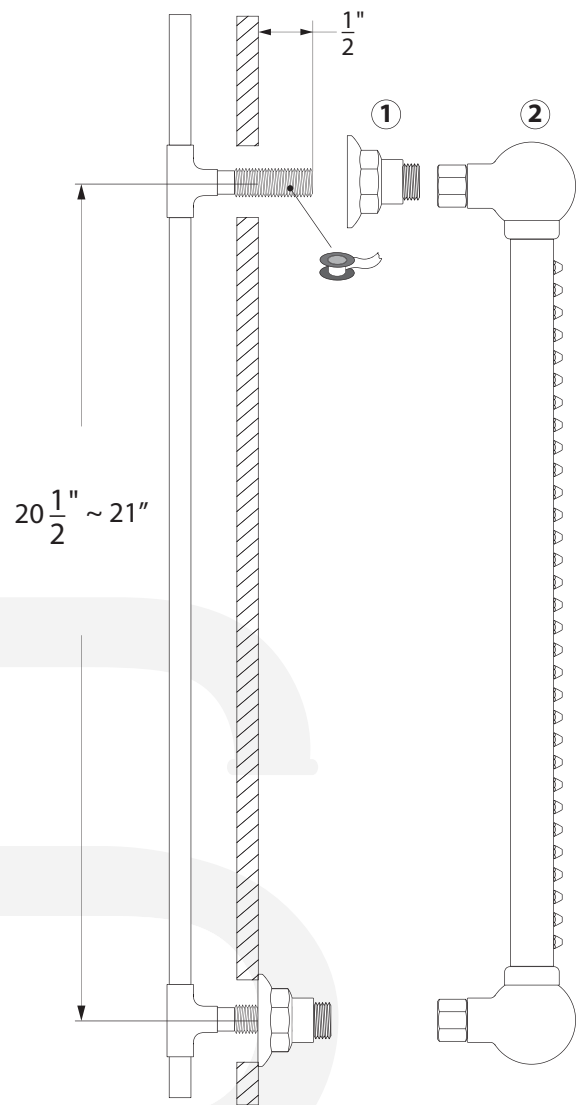

When installing rain bar a pressure balancing loop is required to ensure the performance and spray pressure all nipples on the rain bar are uniform.

1. Install 1/2" NPT copper nipples such that they are 1/2" beyond the surface of the finished wall.
2. The top and bottom nipple must be install with in 20.5" ~ 21" distance apart.
3. Apply teflon tape to the threads on each of the copper nipple.
4. First install the rain bar flange to the supply nipples using an adjustable wrench (use a cloth to protect the finish while tightening)
5. Next, screw the rain bar swivel nuts to the flanges installed on the wall. Make sure that the rubber washers are installed to prevent leakage)
6. Use silicone caulking around the outside of the flange to seal the gap between the wall.

1506-xx

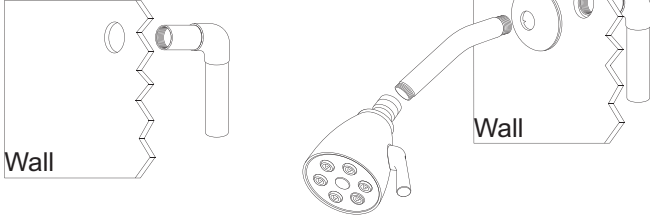

CAUTION: Risk of product damage. To avoid clogging the showerhead spray outlets, use thread sealant tape on the shower arm. Do not use thread sealant compound (pipe dope).
Remove the temporary nipple from the shower elbow and apply thread sealant and install a 1/2" NPT nipple to sit flush against finished wall.
Turn the main water supply on.
Run water through the shower arm to flush out dirt and debris.

Place the wall flange onto the shower arm and flush against the wall.
Apply thread sealant tape to the shower arm, then thread the showerhead assembly onto the shower arm.
Carefully tighten the showerhead to the shower arm with a clean strap wrench.

PLxxASA

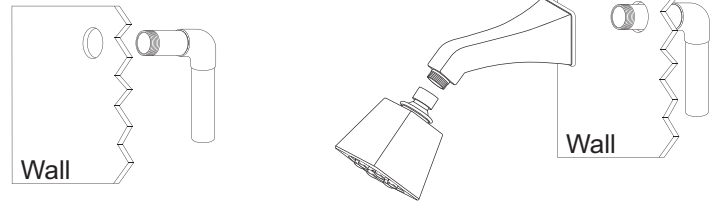

CAUTION: Risk of product damage. To avoid clogging the showerhead spray outlets, use thread sealant tape on the shower arm. Do not use thread sealant compound (pipe dope).
Remove the temporary nipple from the shower elbow and apply thread sealant and install a 1/2" NPT nipple to extend 1" (2.5 cm) beyond the finished wall.
Turn the main water supply on. Run water through the shower arm to flush out dirt and debris.

Make sure the shower arm sits flush against finish wall.
Apply thread sealant tape to the shower arm, then thread the showerhead assembly onto the shower arm.
Carefully tighten the showerhead to the shower arm with a clean strap wrench.

PLxxLSA



CAUTION: Risk of product damage. To avoid clogging the showerhead spray outlets, use thread sealant tape on the shower arm. Do not use thread sealant compound (pipe dope).
Remove the temporary nipple from the shower elbow and apply thread sealant and install a 1/2" NPT nipple to extend 1" (2.5 cm) beyond the finished wall.

Screw the shower arm with flange to the nipple. Make sure the flange sits flush against the finish wall.
Turn the main water supply on.
Run water through the shower arm to flush out dirt and debris.
Apply thread sealant tape to the shower arm, then thread the showerhead assembly onto the shower arm.
Carefully tighten the showerhead to the shower arm with a clean strap wrench.

PLxxFSA

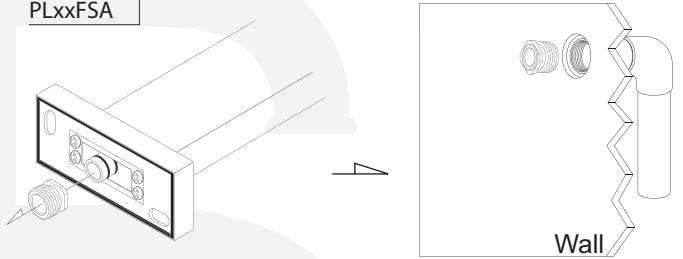

Note: This is a heavy shower arm. The wall area where the arm will be installed must be reinforced to hold the shower arm.
Remove the adaptor nipple from the back of the shower arm.

Use thread sealant tape on the adaptor nipple. Do not use thread sealant compound (pipe dope).
Tighten the adaptor nipple onto the elbow coming from the wall.
Adaptor now needs to be flush with the finish wall.

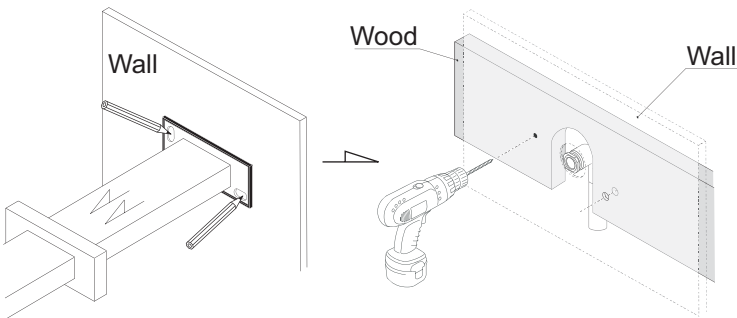

Use an allen wrench and loosen up the set screws on the bottom of the shower flange. Carefully slide back the shower arm flange. Place the metal bracket on the back of the shower arm against the finish wall. Use a pencil to mark the hole locations on the finish wall.

Use a drill and drill in two pilot holes where the screws will be inserted.

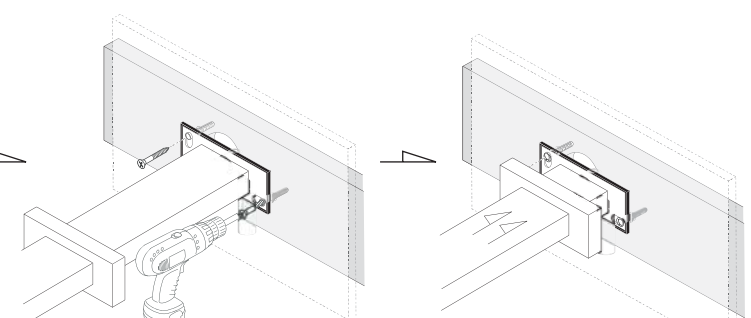

Insert the shower arm onto the nipple adaptor. Place the bracket up against the finish wall. Use a drill and screw the wall screws to the wall. Make sure they sit firm and flush with the finish wall.

Slide the shower arm flange back against the finish wall so that it sits flush. Use the allen wrench and tighten the set screws on the bottom of the flange.

PLHSPxx | **PLRSPxx** | PLCTSxx

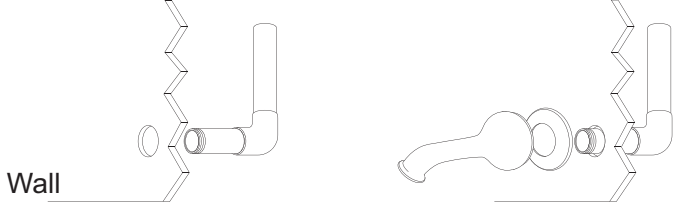

Wall

Apply thread sealant and install a 1/2" nipple so it extends 7/16" (1.1 cm) beyond the finished wall.
Apply a bead of plumbers putty or other sealant around the inlet end of the spout according to the manufacturer's instructions.

Apply thread sealant to the nipple. Place the decorative ring against the finish wall and thread the spout onto the nipple. Make sure the ring and spout sit firmly together and are flush against the finish wall.
Remove all excess putty.

PLWSPxx | **PLBSPxx** | PLTSPxx | PLFSPxx

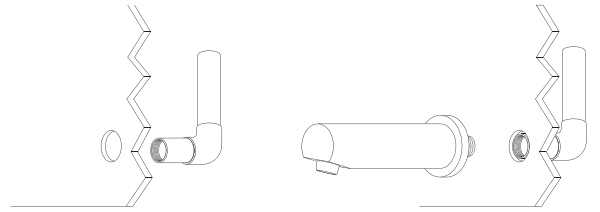

Apply thread sealant and install a 1/2" female adaptor. The adaptor needs to be flushed with the wall.

Apply thread sealant to the back of the spout.
From the back of the spout slide the spout ring over the spout. Connect the male threaded portion of the spout to the female connection outlet from the wall. Adjust the spout and the spout ring. Make sure that the spout ring and the spout sit flush against the finish wall.
Remove all excess putty.

PLASPxx



Apply thread sealant and install a 1/2" female adaptor. The adaptor needs to be behind the wall.
Tighten the spout nipple to the female adaptor. Make sure that the nut portion of the nipple sits flush with the finish wall.

With the spout nipple now in place. Slide the spout over the spout nipple and insert the nipple to the back of the spout. Make sure that the spout sits flush with the finish wall.
Tighten the allen screw underneath the spout with an allen wrench.
Remove excess putty.

PLISPxx | **PLMSPxx**

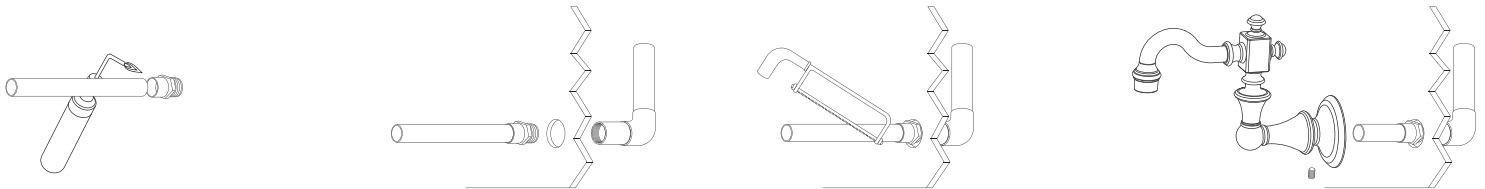

Sweat on a male threaded fitting supplied by H.B. to the end of the copper pipe

After the copper line has cooled off. Connect the copper pipe to the elbow (female adaptor) coming from the wall. Note: the male threaded fitting must be behind the finish wall.

Slide the spout over the copper line and determine the proper cutting location. Remove spout, and cut the copper line.

Finally slide the spout onto copper line. Add plumbers putty to the base of the spout.
Tighten the allen screw underneath the spout with an allen wrench.
Remove excess putty.

Custom shower combination 1

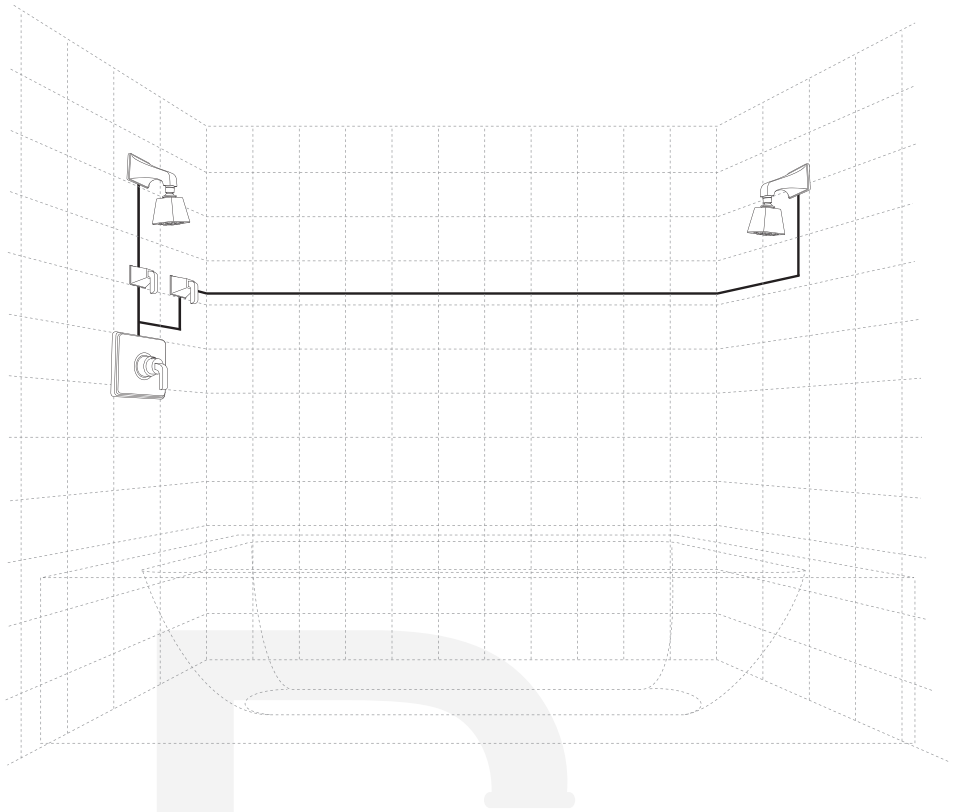
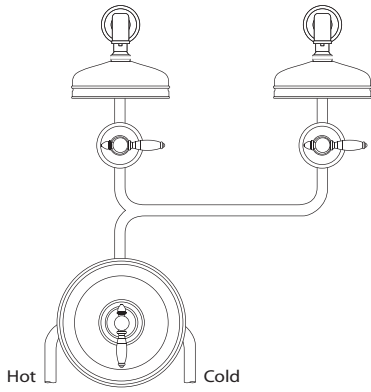

Dual shower heads

1. 2 stop valves will be required for the 2 peripherals to function independently.
2. Note: Adding two stop valve for each shower head will allow you to control the shower heads function independently. (If desired, they can work at the same time, by hooking them up to one stop valve).

Custom shower combination 2

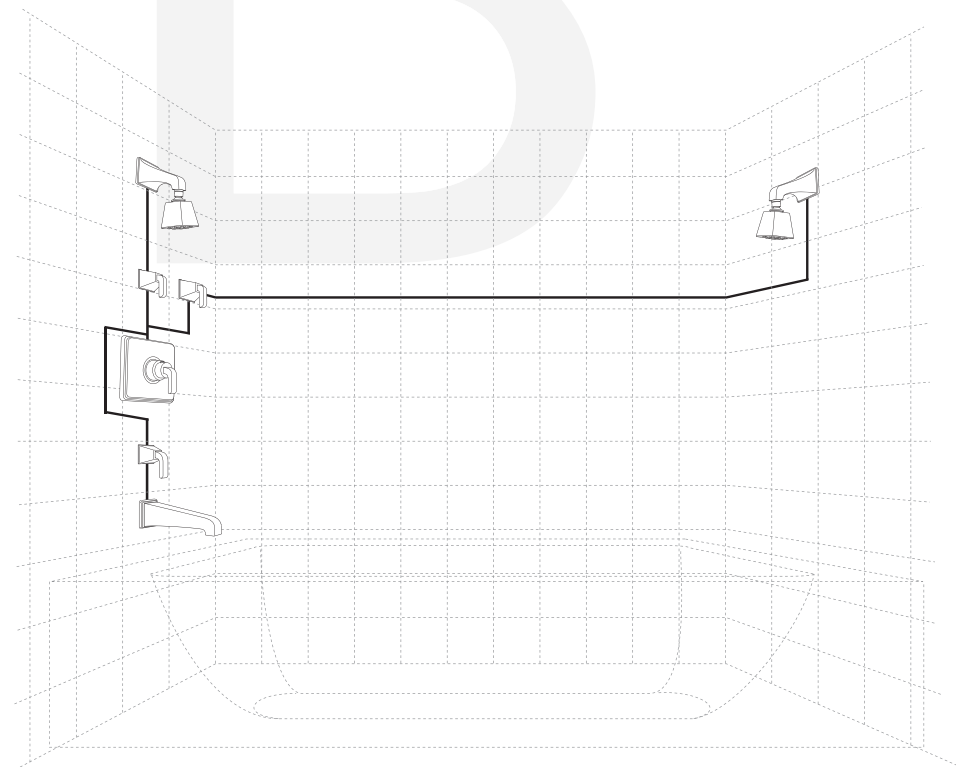
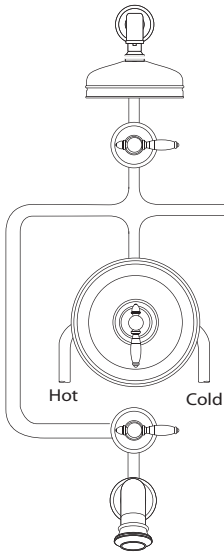

Dual shower heads & tub spout

1. 3 stop valves will be required for the 3 peripherals to function independently.
2. Note: For spout, do not use the opposite outlet on the valve. Use only one outlet for all functions. (Using both outlets will reduce performance of the valve) Spouts vary in installation. Check spout specifications for correct method.

Custom shower combination 3

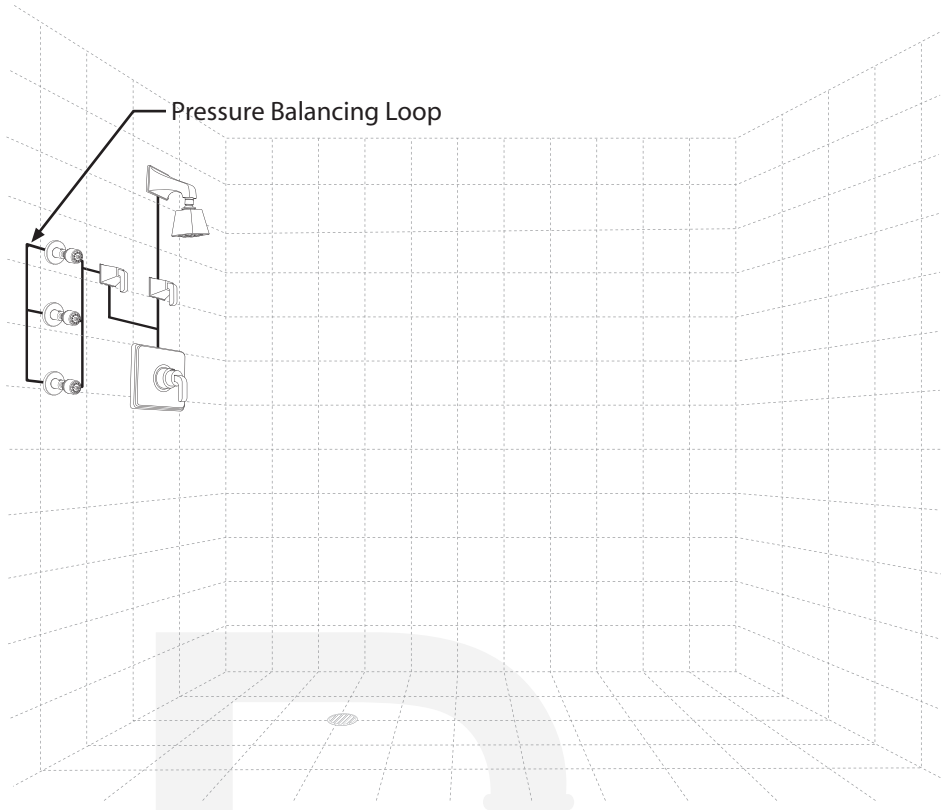
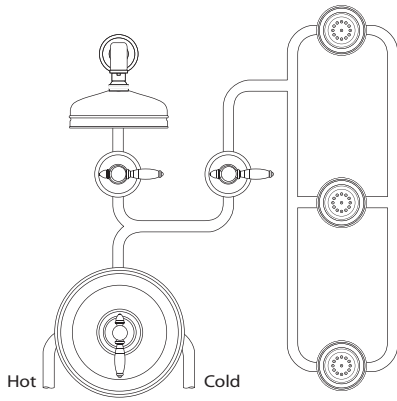

Single shower head & Body Sprays

1. 2 stop valves will be required for the 2 peripherals to function independently.
2. For the body spray installation. 3 body sprays installed in a vertical configuration is standard to achieve total body spray coverage. When installing the body sprays a pressure balancing loop is required. The purpose of this method of installation is to ensure output of each device is uniform.

Custom shower combination 4

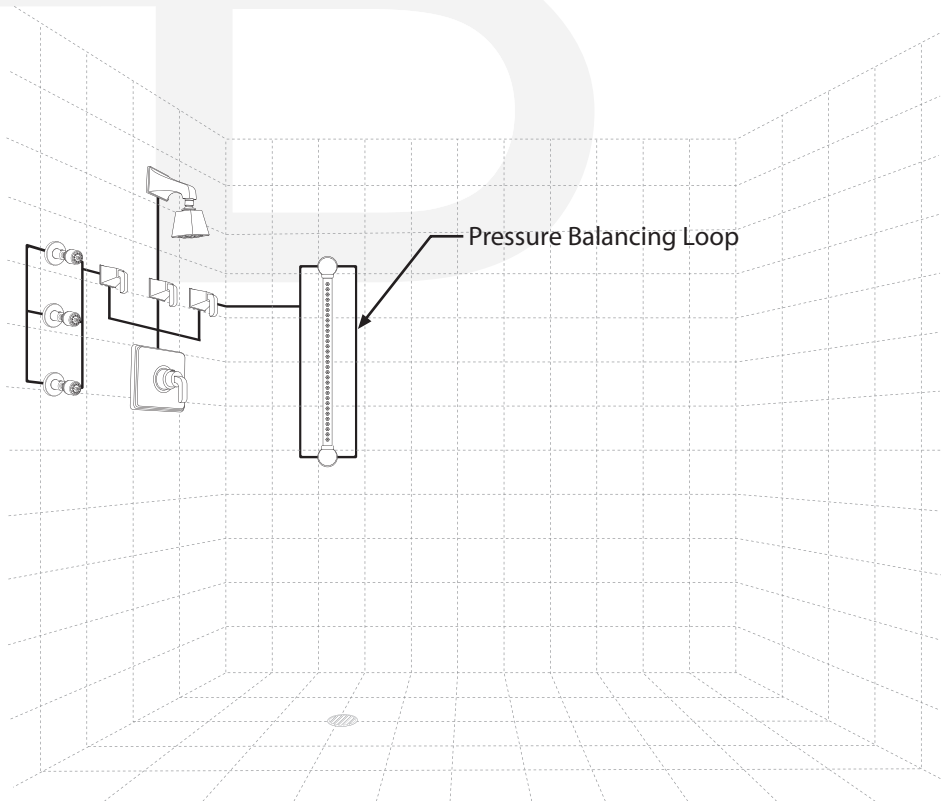
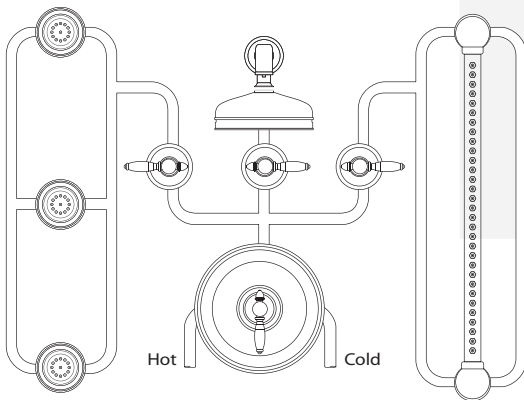

Single shower head, Body Sprays & Rain Bar

1. 3 stop valves will be required for the 3 peripherals to function independently.
2. For the body spray installation. 3 body sprays installed in a vertical configuration is standard to achieve total body spray coverage.
3. When installing the body spray and the rain bar a pressure balancing loop is required. The purpose of this method of installation is to ensure output of each device is uniform.