

Tools You Will Need

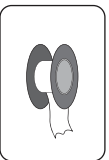

Adjustable Wrench



Pipe Tape



Silicone Caulking



Groove joint plier

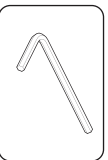

Allen Wrench

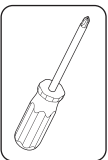

Phillips Screwdriver



Droop Handle

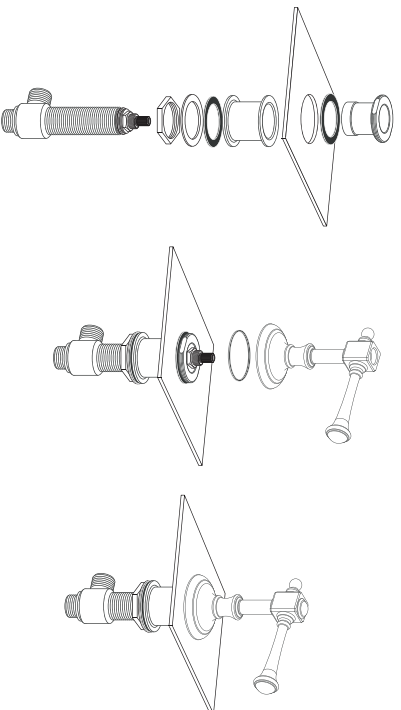

To install the valve bodies first loosen the bottom lock nut on the neck of the valve such that the valve has enough room when placed through the hole from under the counter top. Next, place (Optional) spacer over the valve body. From the bottom slide the valve body up the hole and position the valve body as desired. From the top place rubber washer and metal washer over the valve body so that the washer sits down against the counter top. Screw the adaptor to the top of the valve body. Once valve is in the desired position make sure that the adaptor nut sits securely over the washers. Tighten the bottom lock nut until valve body is secure. Place the handle and escutcheon over the adaptor and valve body stem. Make sure to install with handle in the off position.

Hint: At this point you can test the handle to make sure that the stem position lines up properly. Otherwise you may need to loosen the valve body and adjust the position. (Repeat for other side)

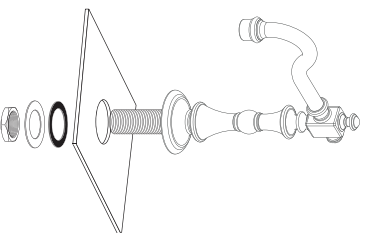

Install spout:

1. Make sure the spout set screw is tight.
2. Now place the spout washer underneath the spout and from the top slip the spout stem down the center hole on the counter top. Make sure that the spout washer sits properly under the spout.
3. From underneath slide the spout stem washer and the round metal flange up the spout stem.
4. Tighten the lock up, up the spout stem. Make sure to make good contact with the deck surface to ensure the spout is secure.

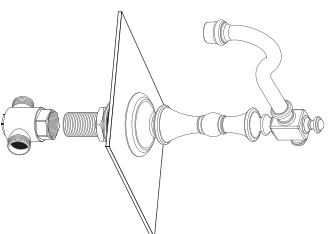

From underneath, tighten the T-connector to the bottom of the spout.

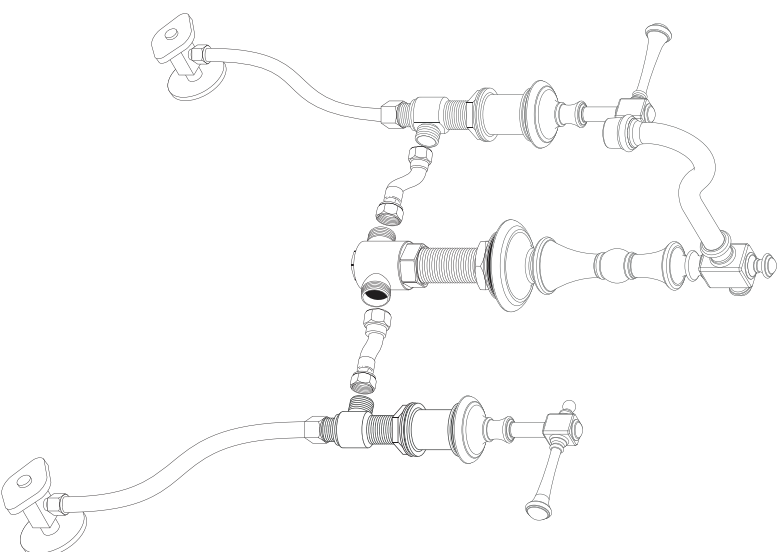

Connect the water supply lines:
Finally connect the water supply lines from the hot and cold valves to the T-connector. Using the steel braided hoses supplied, connect one end first to the side outlets of the valve bodies and the other end to the opening on the T-connector. End hex nut on the hoses should be hand tightened plus an extra 1/2 turn with a wrench. Do not over tighten the hose connections.

Flush the system:
You will need to flush and test the system. Unscrew the aerator from the spout using the aerator lock key provided. Turn the main water supply back on and turn on both the hot and cold valves. Let the water run for about 2-3 minutes. Check above and below the deck surface and at all major connection points for leakage.

Thank you for choosing Huntington Brass. Your new HB faucet is guaranteed to give you a life time of worry free, impeccable function.

