

Tools You Will Need

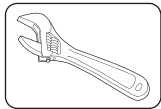

Adjustable Wrench

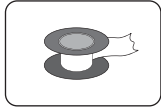

Pipe Tape



Silicone Caulking

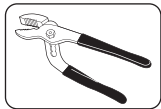

Groove joint plier

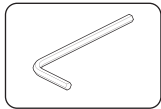

Allen Wrench

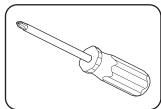

Phillips Screwdriver

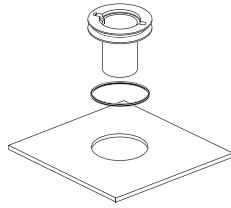

Before installing make sure that if the hole are being drilled into solid surface deck that they are drilled no larger than 1.5". (See specific specs for Spout hole)

1. Place the adaptor washer on the bottom of the escutcheon adaptor.
2. From the top slide the escutcheon adaptor onto the hole for the handles on the deck surface.
3. Make sure that the escutcheon adaptor sits flush down against the counter top

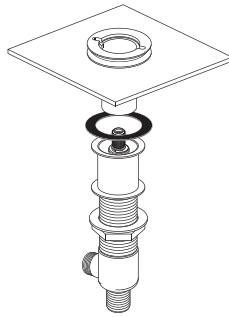

To install the valve bodies first loosen the bottom lock nut on the neck of the valve such that the valve has enough room when place through the hole from under the counter top. Next, place (Optional) spacer over the valve body. From the bottom slide the valve body up the hole and tighten the valve to the escutcheon adaptor. Position the valve body as desired. Screw the adaptor to the top of the valve body. Once valve is in the desired position make sure that the adaptor sits securely over the washers. Tighten the bottom lock nut until valve body is secure.

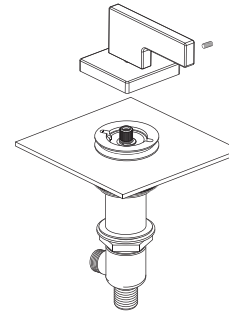

Place the handle and escutcheon over the adaptor and valve body stem. Make sure to install with handle in the off position. Once escutcheon and handle are firmly seated tighten the set screw on the back of the escutcheon so that it holds the escutcheon to the adaptor. Hint: At this point you can test the handle to make sure that the stem position lines up properly. Otherwise you may need to loosen the valve body and adjust the position. (Repeat for other side)

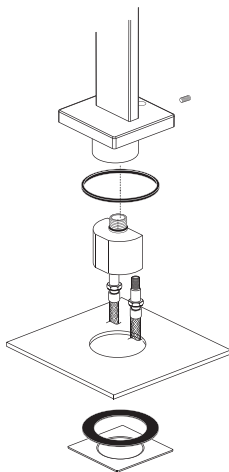

Install spout:

1. Make sure the spout set screw is tight.
2. Connect the hose adaptor to the bottom of the spout.
3. Connect the hoses to the bottom of the hose adaptor. Use an adjustable wrench to tighten the hoses. (Do not overtighten)
4. Now place the spout washer underneath the spout and from the top slip the hoses down the center hole on the counter top.
5. From underneath slip the spout stem washer and the metal square washer up the hoses.

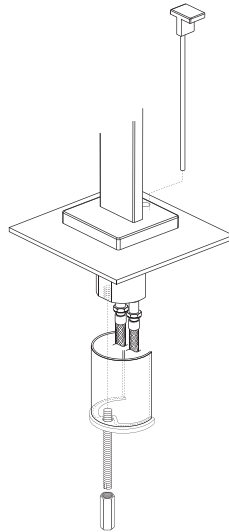

1. Screw the long screw to the bottom of the hose adaptor.
2. Now slip the C-clip up the hoses and through the long screw and set it up flushed against the bottom of the square metal square.
3. Tighten the lock nut to the bottom of the long screw so that it holds the C-clip, metal square and washer onto the bottom of the countertop. (Caution: do not overtighten the spout lock nut) Make sure to make good contact with the deck surface to ensure the spout is secure.
4. Slide the pop up rod down the back of the spout.

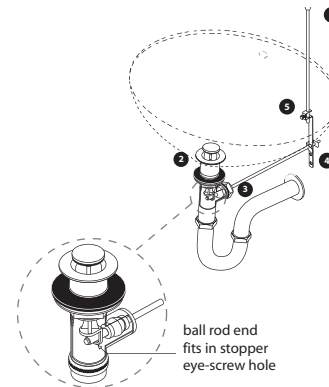

Pop-up Assembly Installations

1. Slide lift rod through hole in faucet spout.
2. Insert pop-up plunger into drain. Hole in bottom of pop-up is to the back of the drain. Remove metal lock nut from hole in back of drain assembly. Remove spring clip from pivot rod.
3. Slide locknut over long end of pivot rod and onto ball. Insert short end of pivot rod into opening in rear of drain assembly. Remember to apply tape or compound to threads. Tighten locknut keeping ball in place. Make sure pivot rod can still move.
4. Slide one end of spring clip onto pivot rod. Slide end of pivot rod through hole in lift rod strap. Slide other end of spring clip onto pivot rod. Pinch spring clip closed.
5. Insert bottom of lift rod into hole at top of lift rod strap. Tighten thumb screw.
6. Connect drain assembly to main drain trap. Insert stopper in collar and hold with eye-screw height by loosening lock nut and rotating counter-clockwise. Tighten lock nut. Fit cone washer and nut to ball rod. Insert ball rod into drain body below so short end of ball rod end fits in stopper eye-screw hole (See Fig A). Be sure that the two ball joint plastic washers are on both sides of the ball rod when installing. Screw on ball rod nut (do not over tighten). Ball rod must move up & down freely

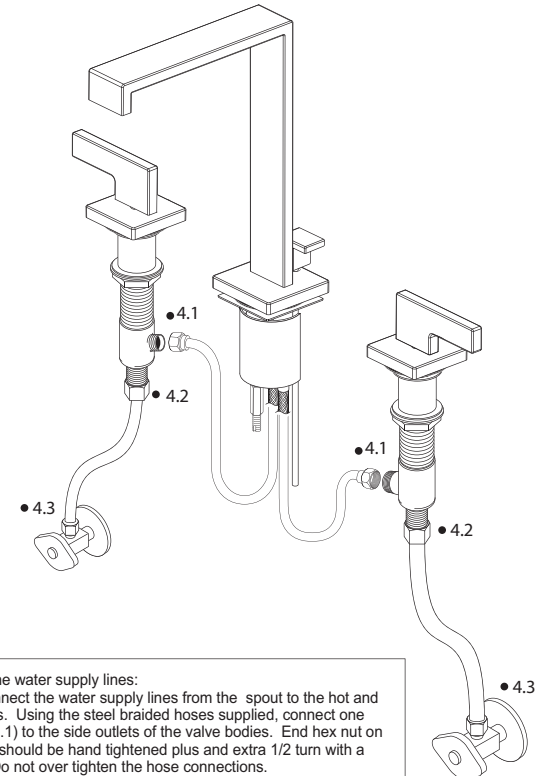

Connect the water supply lines:
Finally connect the water supply lines from the spout to the hot and cold valves. Using the steel braided hoses supplied, connect one end first (4.1) to the side outlets of the valve bodies. End hex nut on the hoses should be hand tightened plus and extra 1/2 turn with a wrench. Do not over tighten the hose connections. Connect the water lines from the house (4.2) to the bottom of the valves. (these hoses are not supplied by H.B.)

Flush the system:
You will need to flush and test the system. Remove the aerator from the spout. Turn the main water supply back on and turn on both the hot and cold valves. Let the water run for about 2-3 minutes. Check above and below the deck surface and at all major connection points for leakage.

Thank you for choosing Huntington Brass. Your new HB faucet is guaranteed to give you a life time of worry free, impeccable function.

