



## Deluxe Thermostatic Package

### Description

---

Deluxe Thermostatic Tub and Shower package Includes:

- Shower arm - (PLxxASA)
- Shower head - (234-xx)
- Handle trim (2) - (ASL-xx)
- Stop valves (2) - (PL2000W)
- Valve trim - (AT8950-xx)
- Thermostatic valve - (PL8950)
- Hand shower - (117-xx)
- Wall bracket - (PL703-xx)
- Hose - (940-xx)
- Supply elbow - (973F-xx)
- No Substitutions Allowed

### Standards

---

- ASME A112.18.1
- IAPMO / UPC & CUPC
- ADA Accessibility Guidelines for Buildings and Facilities - 4.27.4 Controls and Mechanisms (lever handle only)



### Installing the HB 3/4" Thermostatic Valve

---

- The plumbing lines used in installation must be copper pipes
- When soldering copper connections the plumber must first remove the thermostatic cartridge before applying heat. Refusal to follow this step will void the warranty. HB will not be responsible for any damage or defect in function due this neglect.
- Look carefully at the diagrams provided on the installation sheet.
- The HB thermostatic valve is designed to run with only one outlet port open. The valve comes with the bottom port plugged. This plug can be switch if the installation requires it.
- When installing the trim, the stem length may have to be cut to specific dimensions to fit certain styles of trims.

1

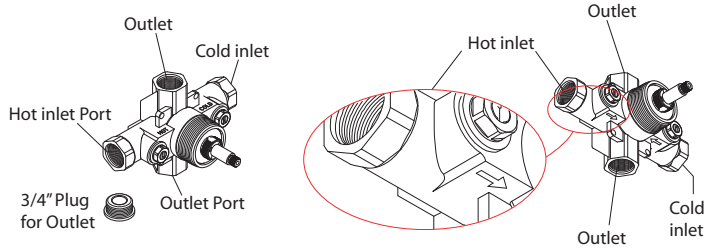

**3/4" PLUG MUST BE INSTALLED IN TOP OR BOTTOM OUTLET**

Please note that the valve is stamped with "HOT" & "COLD" on the top and "C" (chad / hot) and "F" (froid/cold) on the bottom. The valve is designed with two outlets for ease of installation, but are not intended to be used simultaneously. **Using both outlets will make the valve not function properly.** Determine which outlet port will be used for the installation and plug the other outlet with the 3/4" plug provided.

2

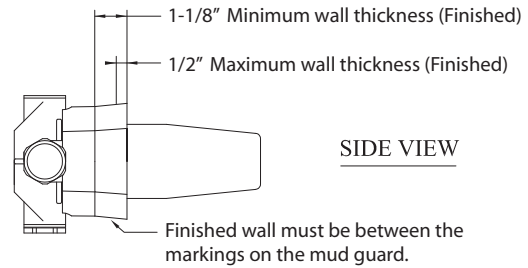

Make sure the tile guide is firmly secured to the valve and determine the proper location for the mixing valve. The from edge of the tile guide must be a minimum of 1/2" beyond the finished wall and no more than 1-1/8". Determine the proper orientation of the valve (see step 1). A reverse cartridge is available, but there is a reduction of 25 percents in the output of the valve.

3

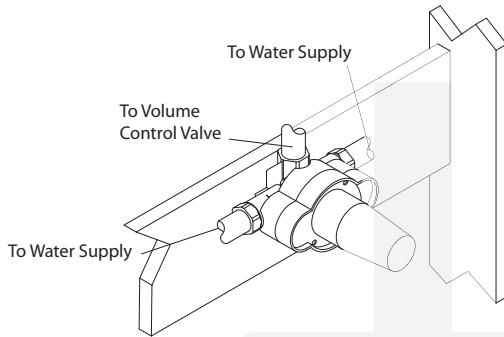

Once the location has been determined, install a cross beam. Level the valve and secure to the crossbeam. Connect the thermostat - mixing valve to the hot and cold supplies using copper supply lines and 3/4" male adaptors. (NOTE: Do not apply heat directly to the valves as this may damage rubber and plastic seals and will void the warranty). Connect the outlet port to the volume control valve (Huntington Brass volume control valves and trim kits are sold separately).

4

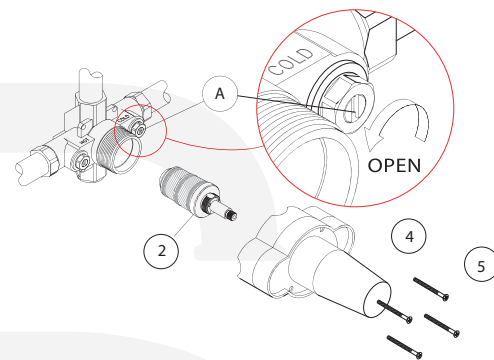

Flush supply lines. Remove the mounting screws (#5) and the tile guide (#4) Close integral stop (#A) by turning screwdriver slots clockwise fully. Remove cartridge (#2) by using a wrench and turning counter clockwise. Turn on water supply and open integral stops by turning screwdriver slots counter clockwise. Shut-off integral stops. Failure to complete this step will void the warranty.

5

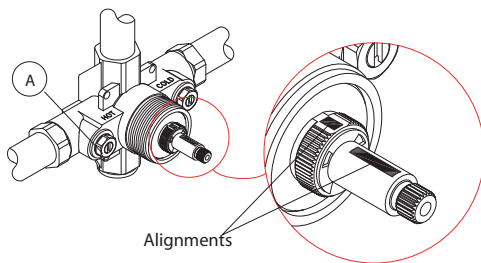

Reinstall cartridge. Make sure that the alignment marks on the cartridge stem are on the top of the cartridge. Secure cartridge back. Open integral stops and flash lines to volume controls (s), outlet (s), etc. Check all connections for leaks. Close integral stops and reinstall tile guide. The wall is now ready to be closed.

6

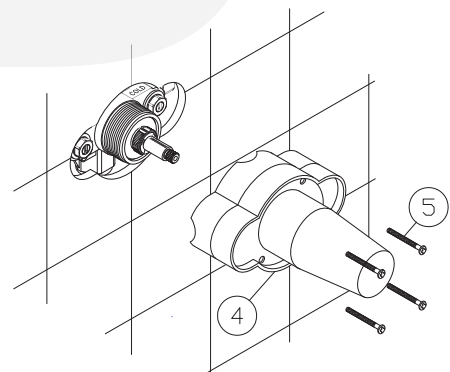

Once the finished wall has been completed, removed black tile guide (#4)

7

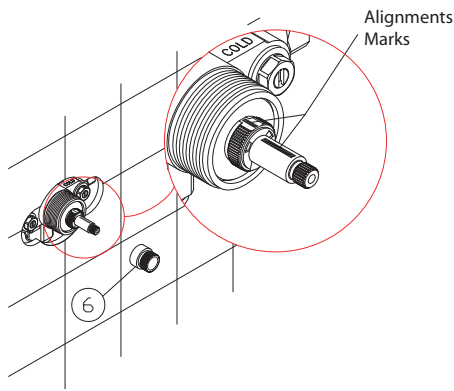

Make sure black alignment mark on the stem lines up with the mark on cartridge nut. Attach positioning cam (#6) to cartridge. Be sure that the fine broach of the cam is aligned with the cartridge and the cam is firmly positioned.

8

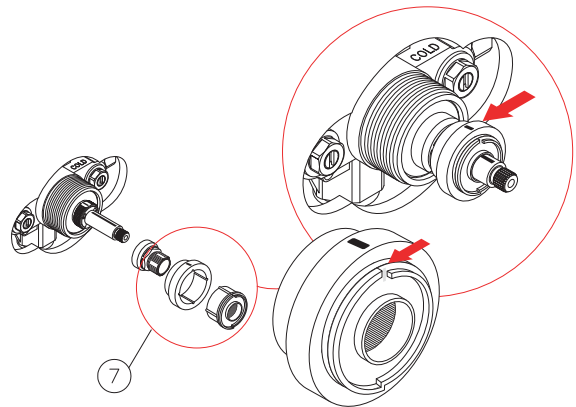

Place the black safety stop insert into the safety stop metal ring. Make sure that the opening in the black safety stop is lined up with the marking on the safety stop metal ring. The cartridges are factory calibrated, so the alignment mark on the safety stop (#7 see insert) must be located at the top. Line up the broach on the safety stop and the positioning cam and slip safety stop (#7) onto positioning cam. Take care not to strip the broach on the safety stop when attaching and be sure that it is firmly positioned.

9

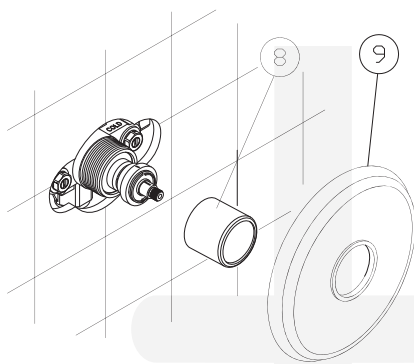

Thread the finished valve sleeve (#8) onto the thermostatic valve body. Check to make sure the seal ring is installed on the center hole of the plate (#9). Slide escutcheon plate onto sleeve until snug against finished wall. Use silicone caulking to seal the plate against the wall surface to avoid any leakage of water behind plate.

10

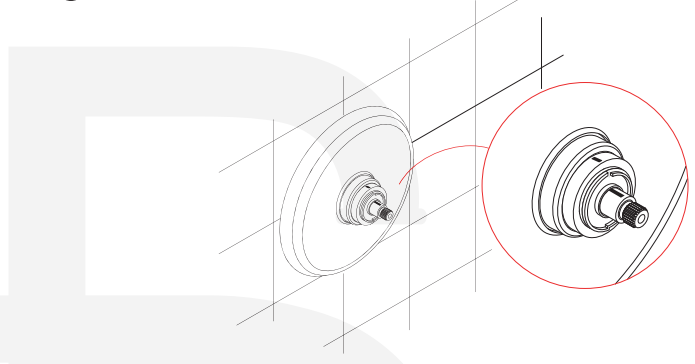

If the finished sleeve does not protrude beyond the finished escutcheon plate, an optional extension (#12) is available. If all installation specifications are followed there should be no need to use the optional extension kit. In the event that the installation instruction are not followed and an extension kit is needed HB does offer these parts, but will not assume any responsibility for the mistake. Please contact your local HB distributor if you have any questions.

11

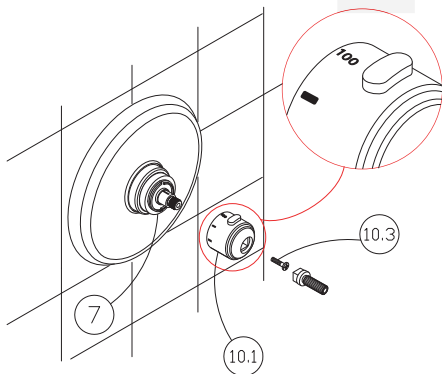

Attach the thermostatic handle base with temperature indicators (#10.1) to safety stop (#7) and stem. The red safety button (marked 100") should be placed at the top. Secure the handle with the screw provided.

12

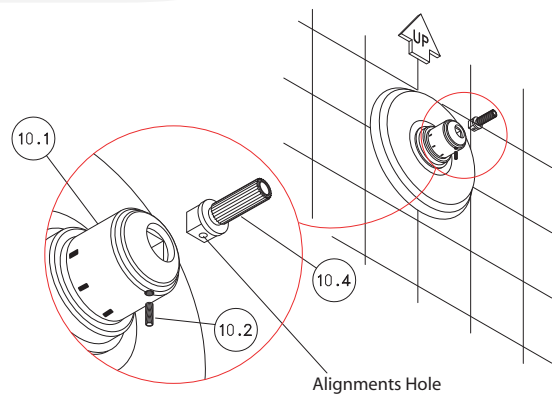

Orient handle broach stem (#10.4) so that the alignment hole is pointed down and insert into the handle base (#10.1). Stem should seat snugly in base with the alignment hole lined up with threads tapped on the underside of the handle base. Secure stem with setscrew (#10.2) provided.

**13**

Finally, attached the handle tip to the stem. (Note: handle trim varies with series and can be mounted in any desired position). The stem may be trimmed to fit if the stem length is too long.

**14**

Once the handle tip is in the desired position, secure the handle tip with the side set screw provided (or some handles may use a top side screw that will screw into the tapped thread in the broach stem)

### Extension Kit Installation

Extension Kit

The thermostatic valve extension kit consists of 3 main components. 1) Broach extension 2) positioning cam extension 3) sleeve extension & 4) long handle screw. All of these parts are easily installed on to the valve body with out making any adjustments.

First, place the broach extension piece on to the thermostatic cartridge broach stem. This will later be secured when the handle trim is installed using the longer handle screw to reach the broach thread. Next, place the cam extension onto the cartridge.

Next, follow the same directions as step #8 in the installation instructions to assemble and install the safety stop ring onto the positioning cam extension piece.

When installing the safety stop ring make sure to line up the marking on the metal ring with the collaboration markings on the cartridge placing all marking aligned at the top position.

Finally, install the sleeve extension onto the valve body. Once all of the extension components are installed you can install the rest of the trim parts as normal using the long screw for the handle trim in place of the existing short screw.

### Important

Valve stem & thread will have to be cut differently to fit various trims. Make sure that no part of the valve is altered until trim is in hand ready to install. HB will not assume responsibility for installation negligence.

#### 1 Finding the "L" Dimension

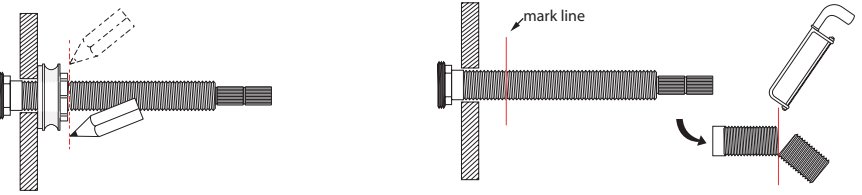

To find the "L" dimension after the rough-in is installed and the finished wall is completed, first install the handle escutcheon. Mark the threaded nipple where the escutcheon ends. Remove the nipple by unscrewing and then cut the nipple 1/8" below the marking to ensure that the handle tip will fit flush with the escutcheon. Once the nipple is cut to the proper length, reinstall onto the cartridge stem, and prepare to measure the "T" dimension for the stem length.

#### 2 Finding the "T" Dimension

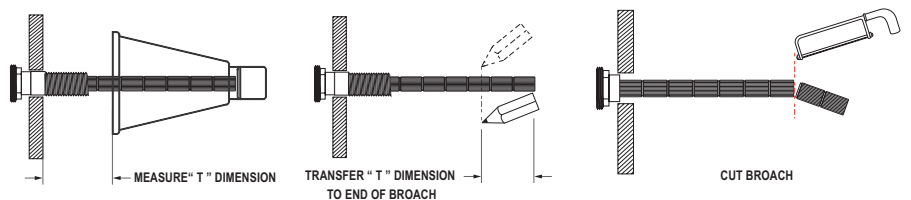

To find the "T" dimension, first reinstall the handle and escutcheon onto the broach stem. Measure the distance between the wall and the bottom of the escutcheon. Remove the handle and escutcheon from the broach and transfer those dimensions to the end of the broach. Next, cut the broach to the specific "T" dimension. Cut the broach stem at the notch area if possible, if not then some filing of the end of the stem may be needed to fit the handle tip on the stem.

#### 3

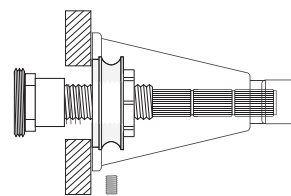

Finally, after the threaded nipple and the stem are cut to the proper dimensions, you can install the Escutcheon and handle trim parts. HB advises using silicone caulking where the wall and the escutcheon meet. Make sure the handle tip is pointed down in the off position.

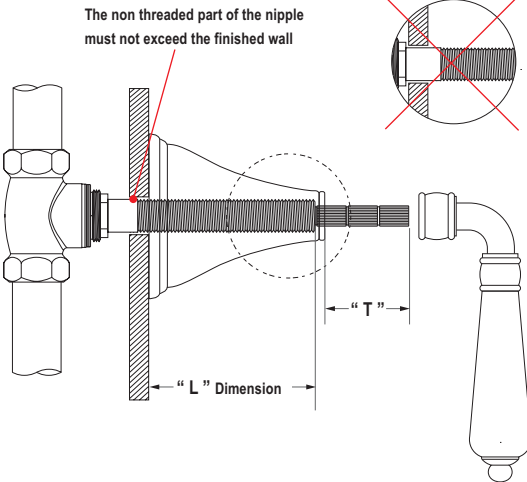

### Before Installing Handle Trim

1. "L" dimension - The "L" dimension is the length that the all thread (9/16-20) nipple should be cut to for applicable trim installation. To find the "L" dimension, see step 1 of the trim installation process.

2. "T" dimension - The "T" dimension is the length of the stem that should protrude from the escutcheon base after the nipple is marked, cut and installed back on the valve.

### Atlantis

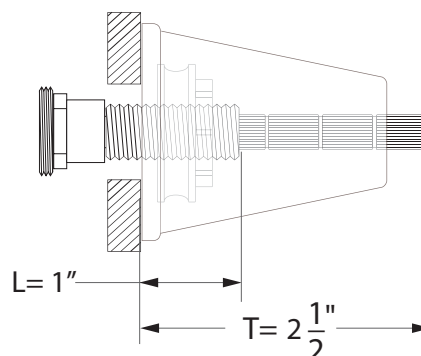

Approximate Dimensions depending on your wall surface material.

IMPORTANT: Make sure to turn off the main water supply before you begin

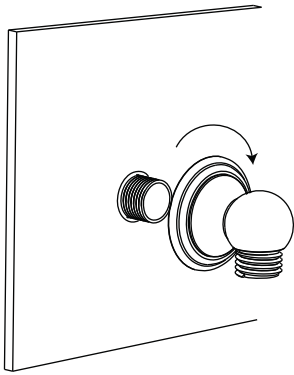

1. Tighten supply elbow to the 1/2" supply pipe.

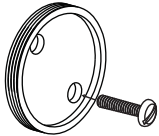

2. Install wall bracket onto the wall at your desired location.

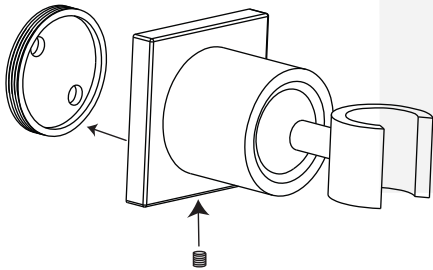

3. Install trim ring onto the hand shower holder. Thread hand shower holder onto the wall bracket. Tighten set screw on the trim ring when everything is in the desired position.

4. Tighten hand shower onto hose, attach hose to the supply elbow.

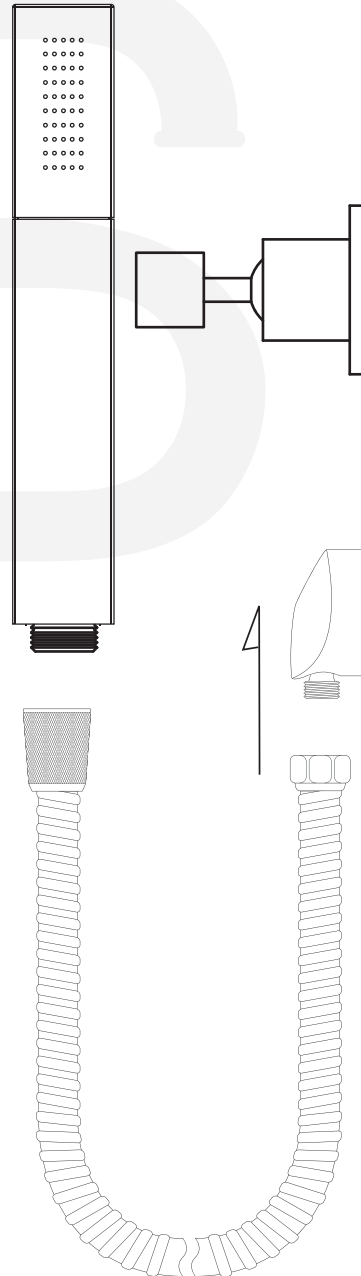

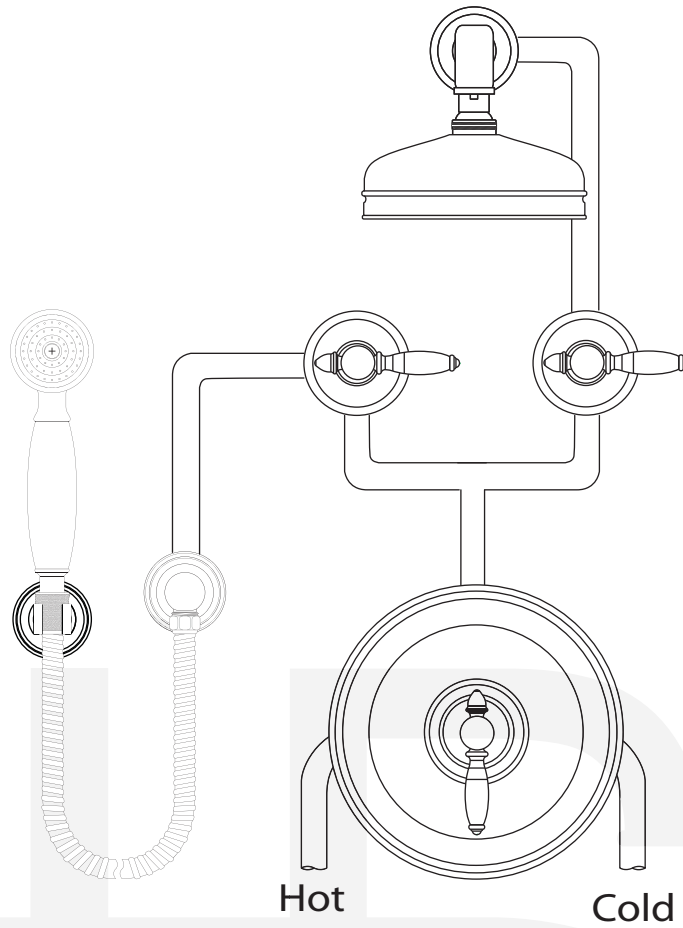

### Recommended plumbing layout

1. Two Stop valves will be required for the two peripherals to function independently.
2. Note: For hand shower, do not use the opposite outlet on the valve. Use only one outlet for all functions. (Using both outlets will reduce performance of the valve).