

CT66BBI

33.25" x 23.63" x 23.5" (H x W x D)

Built-in undercounter refrigerator-freezer for general purpose use, with dual evaporator cooling, cycle defrost, and black exterior

Highlights:

Flexible design allows built-in or freestanding use in 24" spaces

Zero degree freezer compartment

Improved temperature performance with our unique dual evaporator cooling

Includes adjustable glass shelves for spill-proof storage



Built-in capability	Make the best use of space by installing your refrigerator under the counter and flush with other cabinets
Cycle defrost	This system utilizes user-friendly automatic defrost operation in the fresh food section and efficient manual defrost operation in the freezer compartment
Zero degree freezer	Static manual defrost freezer section offers more stability
Thin-line design	Our unique 24" wide models offer full capacity in a slim fit
Adjustable thermostat	Dial thermostat located inside for easy temperature management
Interior light	Automatically illuminates when you open the door
Adjustable glass shelves	Rearrange your refrigerator space to accommodate all shapes and sizes or remove shelves for a simple clean-up
Fruit and vegetable crisper	Get the longest life and best taste out of produce by storing it in a convenient slide drawer
Door storage	Store tall bottles and condiments right on the door for convenient access
Dual evaporator	Our unique and efficient design separately cools the refrigerator while maintaining zero degrees in the freezer with two evaporators

CT66BBI Specifications:

Height	33.25 up to 34.5"
Width	23.63"
Depth	23.5"
Capacity	5.1 cu.ft.
Ext Depth with Handle	25.0"
Interior Height 1	19.5"
Interior Width 1	20.5"
Interior Depth 1	17.0"
Interior Height 2	5.0"
Interior Width 2	19.0"
Interior Depth 2	11.5"
Comp Step Height	7.0"
Comp Step Width	20.5"
Comp Step Depth	5.0"
Height Adjustable	true
Shipping Weight	109.0 lbs.
US Electrical Safety	UL
Voltage/Frequency	115 V AC/60 Hz
Amps	1.3
Canadian Electrical Safety	ULC
Reversible	Yes
Door Swing	RHD
Crisper Quantity	1
Shelf Quantity	3
Adjustable Shelf	true
Shelf Type	Glass
Crisper Cover Type	Glass
Crisper Finish	Transparent
Full Door Shelf Quantity	3
Defrost Type	Cycle
Height to Hinge Cap	34.5"
Depth with door at 90°	45.75"
Thermostat Type	Dial
Fan Type	Exterior
Light	true
Low Side PSI	70.0
Level Legs Quantity	4
Refrigerant Type	R134a
High Side PSI	285.0
Freon Oz	2.6
Compressor Warranty	5 Years
Parts/Labor Warranty	1 Year

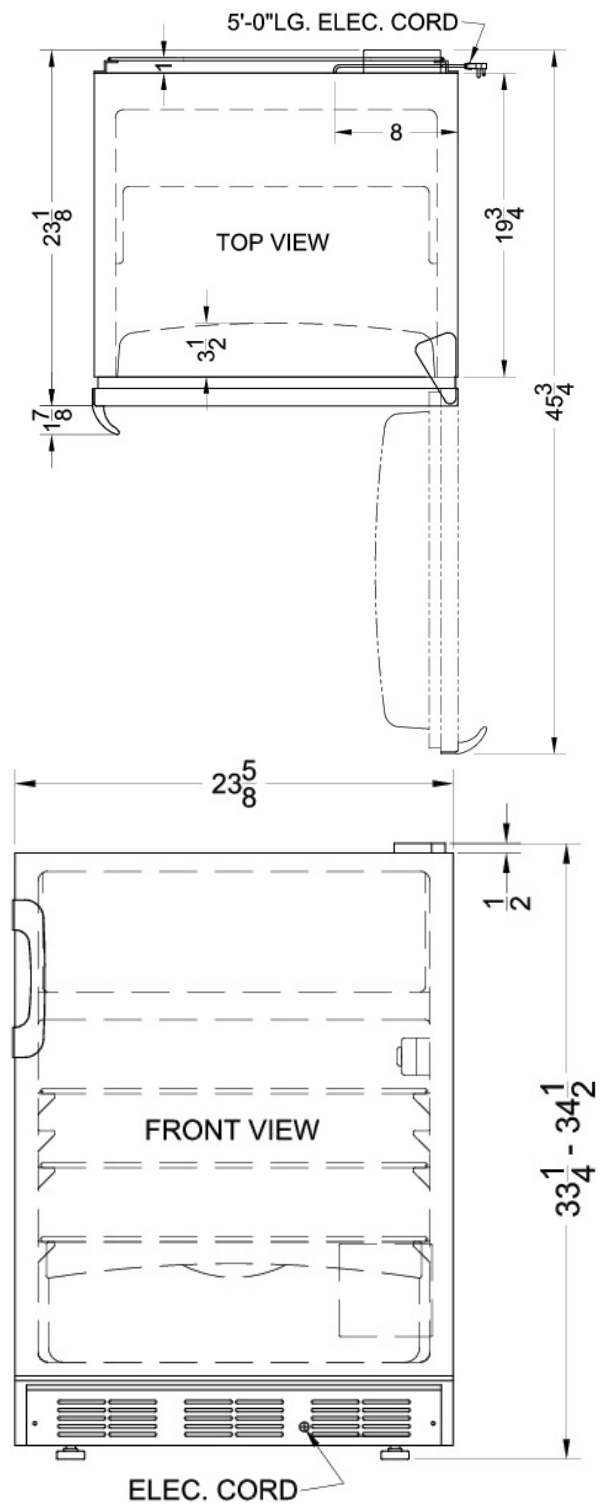

Summit Appliance Division, Felix Storch, Inc.
 770 Garrison Ave • Bronx, NY 10474
 Phone: 718-893-3900 • Fax: 718-842-3093
 Email: info@summitappliance.com